

# PODVOYAGER

PRODUCT BROCHURE





PODVOYAGER

Your Capsule, Your World





## COMPANY PROFILE

PodVoyager specializes in the design and manufacture of advanced Capsule Houses, offering modern, eco-friendly solutions for luxury accommodations, cultural tourism, and camping. Our capsules are designed for comfort, sustainability, and easy installation, providing a unique living experience in diverse environments.

With customizable options, sleek designs, and a focus on energy efficiency, PodVoyager capsules are ideal for resorts, glamping sites, and off-grid living. Our products are built to withstand various climates, ensuring long-lasting durability and minimal environmental impact.

Choose PodVoyager for innovative, high-quality space capsules that redefine the concept of portable living spaces.





# 01

## STRICT QUALITY CONTROL

We implement rigorous testing and quality inspection standards, with multiple inspection processes from raw material selection to final product delivery, ensuring each product meets industry-leading quality levels.

# 02

## COMPREHENSIVE TECHNICAL SUPPORT

We provide thorough technical support, adhering to strict industry regulations from design to construction, and are equipped with complete emergency facilities and preventive measures to ensure customer safety and peace of mind.

# 03

## EFFICIENT CUSTOMIZATION SERVICES

Beyond production capabilities, we offer end-to-end customization services, from product design to development, tailored to meet the unique needs of different regions and application scenarios.



**2011**

Compass Decor has been established.

**2019**

The company expands into the prefabricated housing industry.

**2020**

The "space capsule" concept is introduced.

**2021**

The second generation capsules are invented.



**2022**

The "C series" space capsule is developed.

**2023**

Committed to its roots, we drive innovation to build a global brand.

**2024**

Sales expand to more than 15 countries.

**2025**

The company will stick to its original aspirations, continue to innovate, and build a world-class brand.





Pitched roof

270-degree viewing bedroom

Smart viewing sunroof

360-degree invincible double-view balcony

Warm design of small living room

Smart security combination lock

High-tech explosion-proof glass



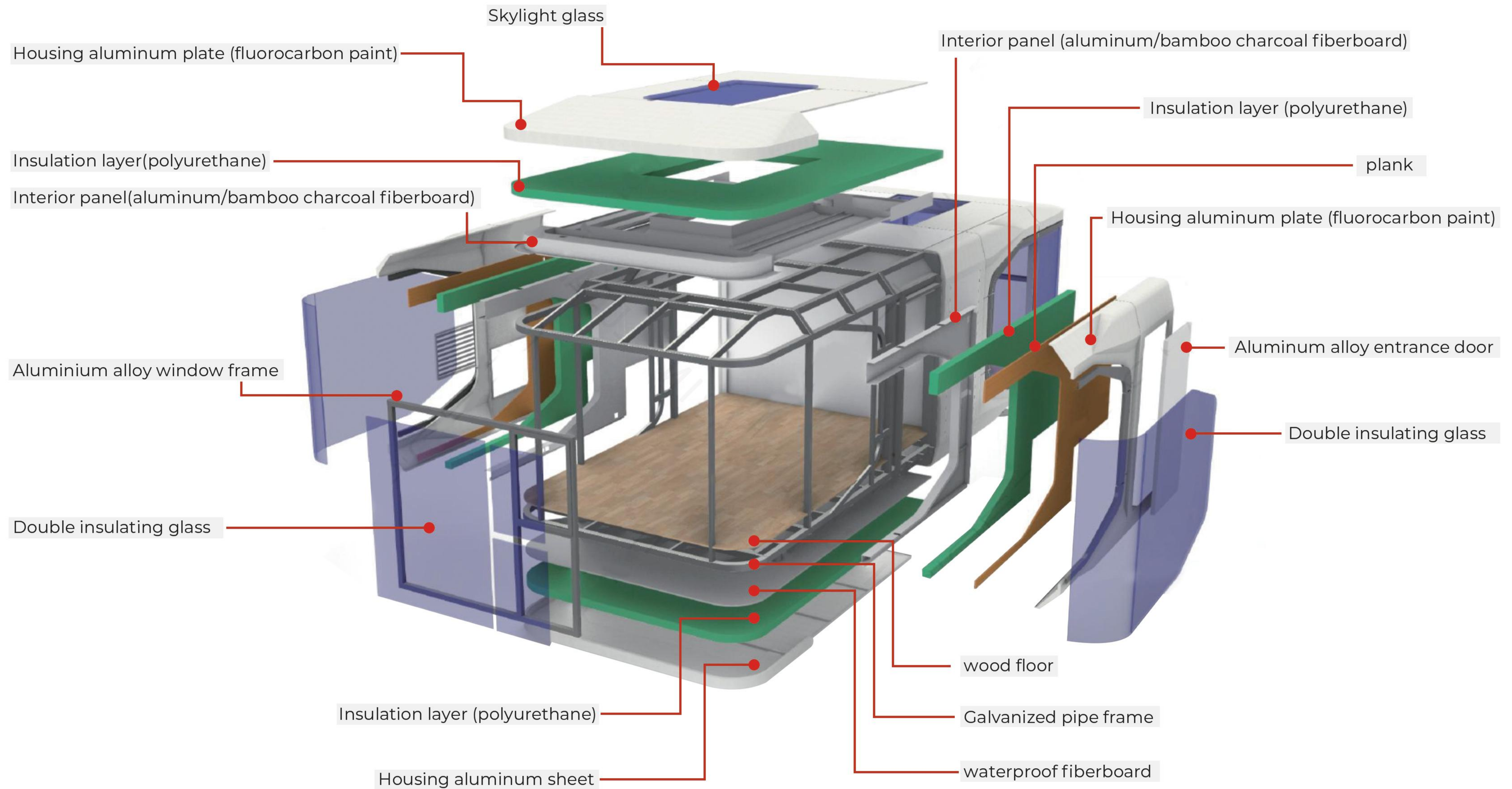

**Product Internal Structure Diagram**



STANDARD FUNCTION

1.Double Tempered Hollow Ford Blue Glass	11.Delixi Leakage Protection System
2.Customized Baking Painted Aluminum Interior Wall	12.LED Low Voltage 24V Flicker-Free Linear Light
3.Cement Fiberboard + SPC Flooring	13.Graphene Electric Floor Heating
4.JOMOO Smart Toilet	14.Electric Honeycomb Curtain
5.JOMOO Washbasin, Countertop and Smart Bathroom Mirror	15.Whole House Intelligent Voice Control System
6.Haier 60L Storage Water Heater	16.XGIMI Z7X Projector
7.Haier Integrated Bathroom Heater	17.Luxurious High Quality Sofas
8.JOMOO Shower Set	18.2*1.8m Double Bed with Mattress
9.Gree 3P Central Air-Conditioning	19.High Quality Durable Tables and Chairs
10.Class A Security Door	20.Balcony





## 01.WIND RESISTANCE

---

Designed to withstand up to Grade 9 wind pressure, the space capsule's reinforced columns and beams ensure stability and durability even under strong winds and vibrations.

## 02.CORROSION & INSECT PROTECTION

---

Constructed with high-grade, corrosion-resistant aluminum alloy, the exterior is treated to prevent insect infiltration, ensuring a long-lasting, low-maintenance solution.

## 03.FIRE & WATER RESISTANCE

---

Equipped with high-grade flame-retardant and waterproof materials, the structure effectively withstands fire risks and heavy rainfall, providing reliable protection in extreme weather.

---

## 04.THERMAL INSULATION

---

Advanced insulation materials maintain a comfortable interior temperature, reducing energy consumption and keeping occupants comfortable across various climates.

## 05.SOUND INSULATION

---

Built with sound-dampening materials, the capsule reduces external noise by up to 45 decibels, ensuring a peaceful and quiet living environment.

## 06.SECURITY & ANTI-FREEZE PROTECTION

---

Enhanced with secure locks and anti-freeze technology, the capsule offers year-round safety and functionality, protecting against theft and harsh winter conditions.



PODVOYAGER



INTEGRATED KITCHEN



WARDROBE



CUSTOMIZE SHAPE









AQUARIUS SERIES

V-8B

V-8B : L : 11.5M W : 3.3M H : 3.3M P : 15



AQUARIUS SERIES

V-8

V-8 : L : 11.5M W : 3.3M H : 3.3M P : 16

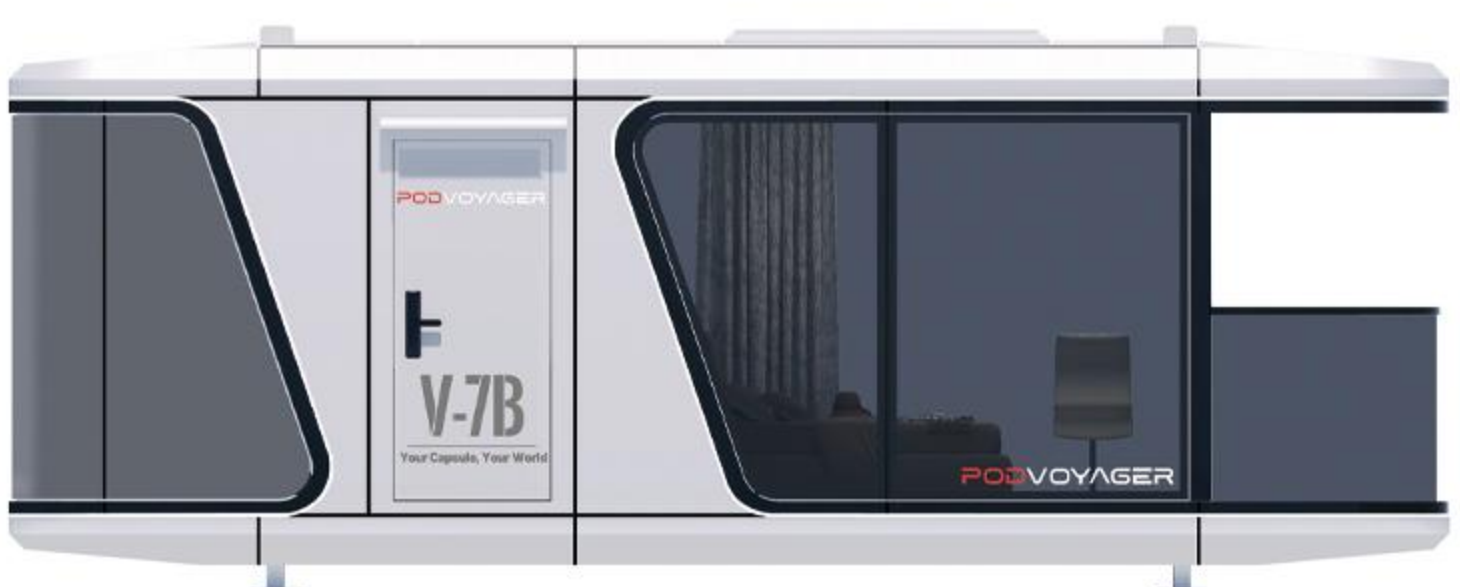

AQUARIUS SERIES

V-7B

V-7B : L : 8.5M W : 3.3M H : 3.3M P : 17

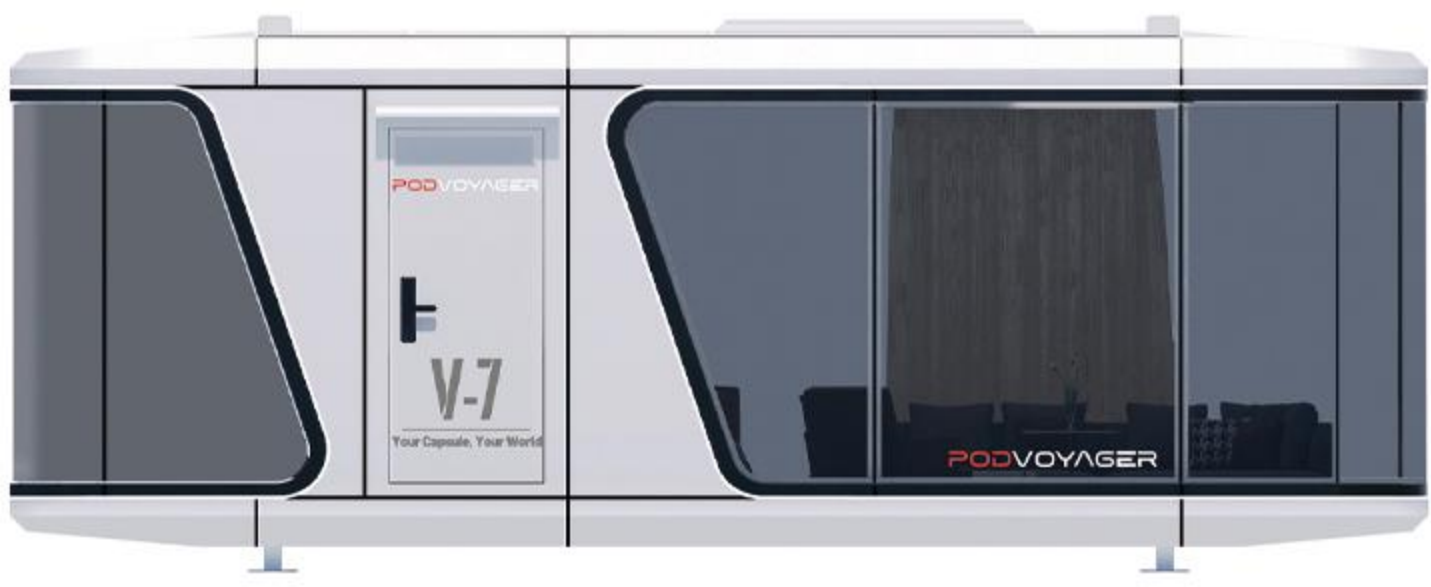

AQUARIUS SERIES

V-7

V-7 : L : 8.5M W : 3.3M H : 3.3M P : 18



AQUARIUS SERIES

V-3

V-3 : L : 5.5M W : 3.3M H : 3.3M P : 19



PISCES SERIES

X-8B

X-8B : L : 11.5M W : 3.3M H : 3.3M P : 20



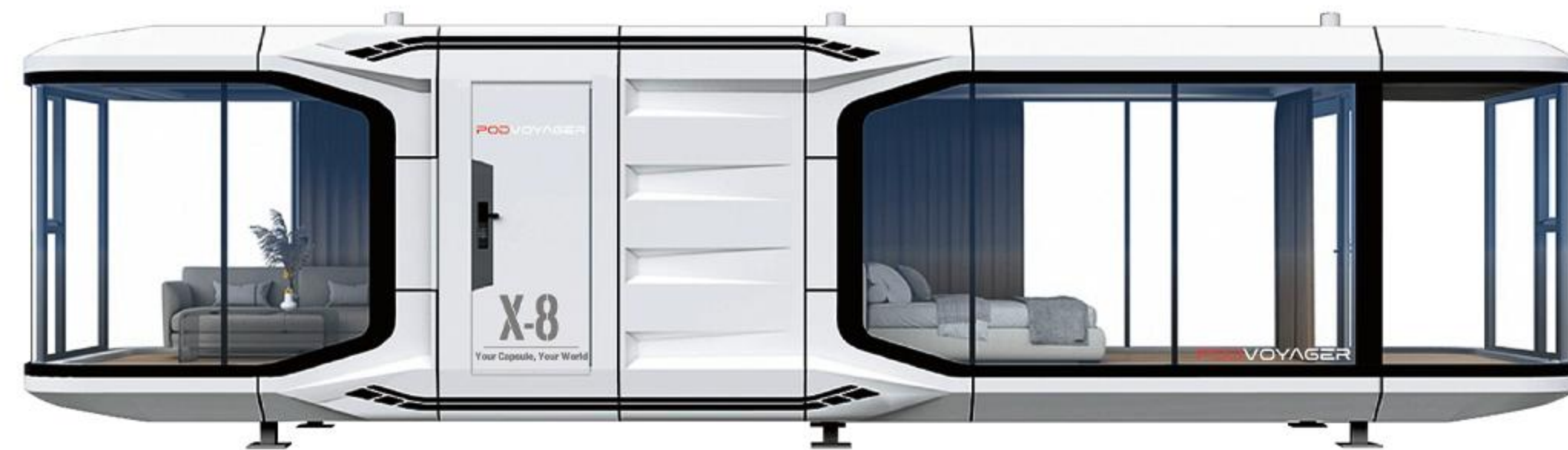

PISCES SERIES

X-8

X-8 : L : 11.5M W : 3.3M H : 3.3M

P : 21



PISCES SERIES

X-7B

X-7B : L : 8.5M W : 3.3M H : 3.3M

P : 22



PISCES SERIES

X-7

X-7 : L : 8.5M W : 3.3M H : 3.3M

P : 23



ARIES SERIES

T-7

T-7 : L : 8.5M W : 3.3M H : 3.3M

P : 24



TAURUS SERIES

C-8

C-8 : L : 11.5M W : 3.3M H : 3.3M

P : 25

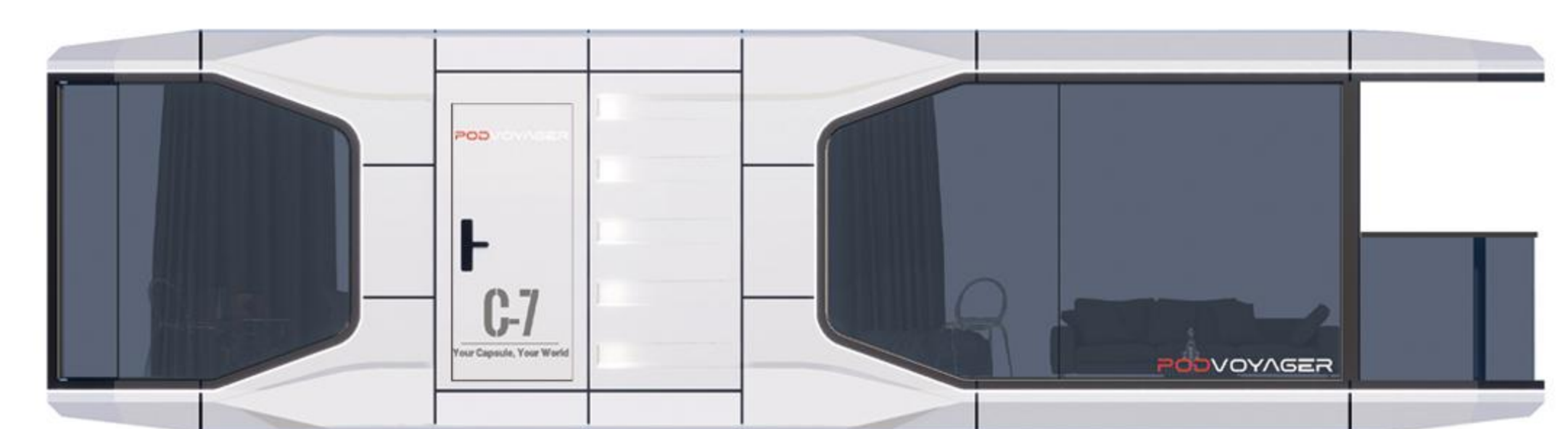

TAURUS SERIES

C-7

C-7 : L : 8.5M W : 3.3M H : 3.3M

P : 26





GEMINI SERIES

A-8

A-8 : L : 11.5M W : 3.3M H : 3.3M

P : 27

EXPLORE MORE MODELS AND DESIGNS OF OUR CAPSULE HOUSE PLEASE GET IN TOUCH WITH US

.....





**GEMINI SERIES**

**Z-8**

Z-8 : L : 11.5M W : 3.3M H : 3.3M



**TAURUS SERIES**

**E-8**

E-8 : L : 8.5M W : 3.3M H : 3.3M

## OEM PRIVATE CUSTOMIZATION

- 1.Exterior Color and Material Customization
- 2.Interior Layout and Functional Module Customization
- 3.Smart Home System Integration
- 4.Eco-Friendly and Energy-Efficient Upgrades

"Customize your dreams, achieve your uniqueness!"



**GEMINI SERIES**

**Z-7**

Z-7 : L : 8.5M W : 3.3M H : 3.3M

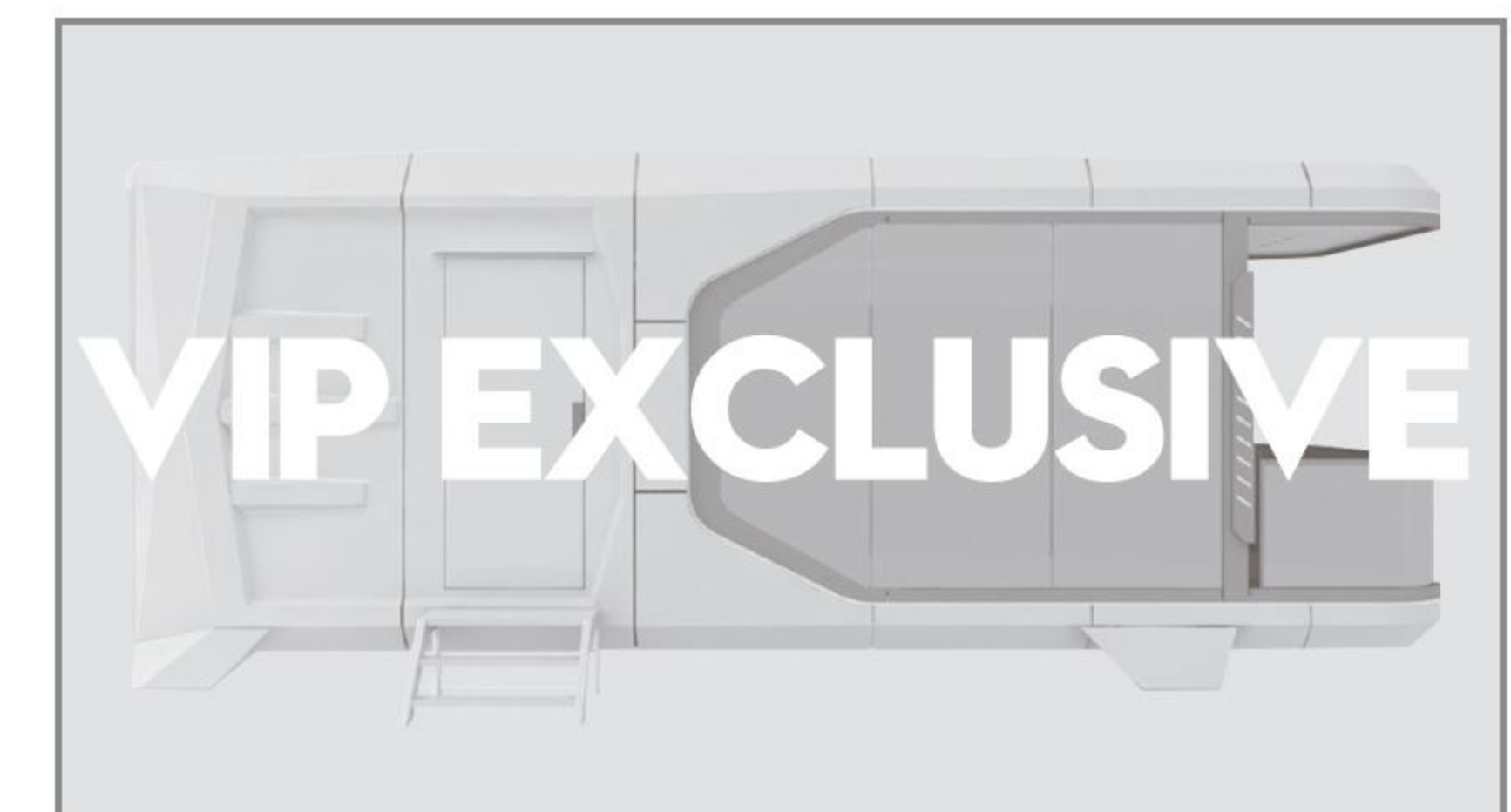

**TAURUS SERIES**

**E-7**

E-7 : L : 8.5M W : 3.3M H : 3.3M



PODVOYAGER

# V-8B

## AQUARIUS SERIES

Domestic Version



Export Version

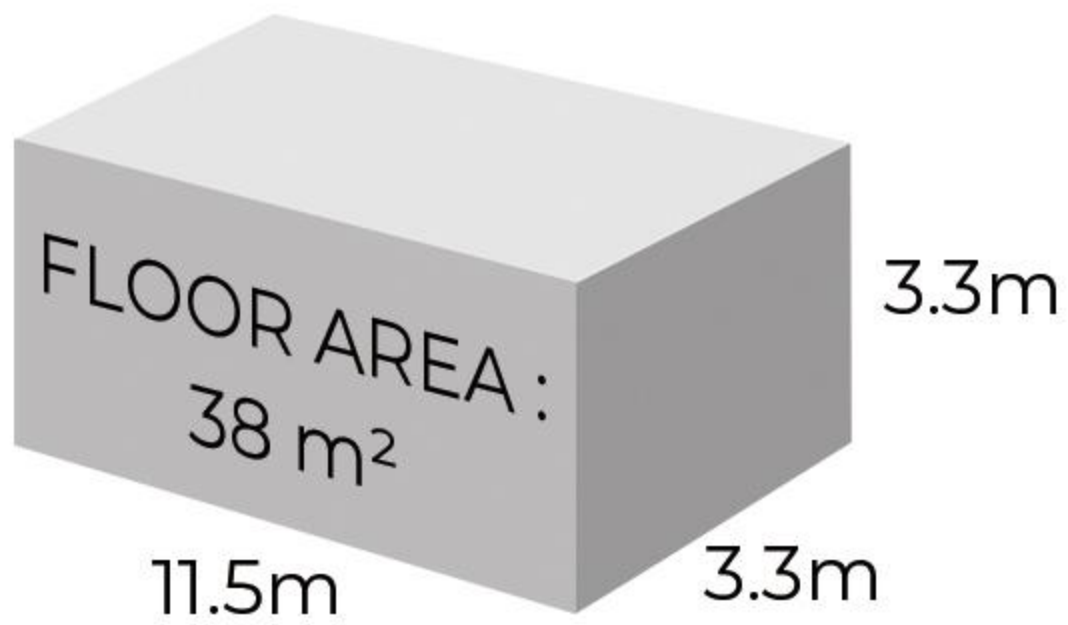

V-8B

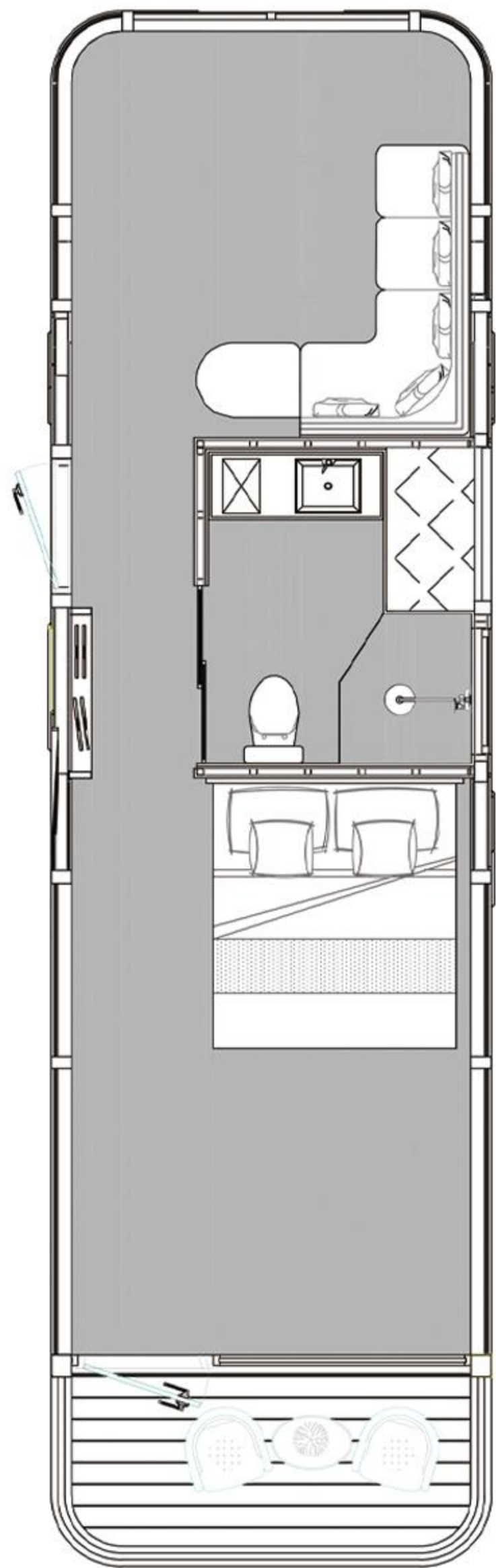

<b>MAIN STRUCTURE:</b>	Thickened Steel Frame, Aluminum Exterior Panels, Polyurethane Insulation Layer, Panoramic 6+12+6 Glass Wall Curtain , Aluminum Doors and Windows, Intelligent Access Control, Supporting Tubes.
<b>INTERNAL STRUCTURE:</b>	Aluminum Wall Panel, Waterproof Composite Wood Floor, Indoor and Outdoor Multi-Color Warm Light, Electric Curtain, Large Skylight, Whole-House Intelligent Control System, Branded Socket Panel.
<b>SANITARY WARE:</b>	Glass Side Sliding Door, Smart Toilet, Water Heater, Shower, Branded Basin, Branded Faucet.
<b>MAIN EQUIPMENT:</b>	Gree Central Air Conditioner, Water Heater, Multi-Function Integrated Bathroom Heater With Ventilation and Heating.
<b>MATCHING:</b>	Electric Floor Heating, Water Pipe Antifreeze, Projector, Fire and Smoke Alarm, Starry Roof.



# V-8

## AQUARIUS SERIES

Export Version

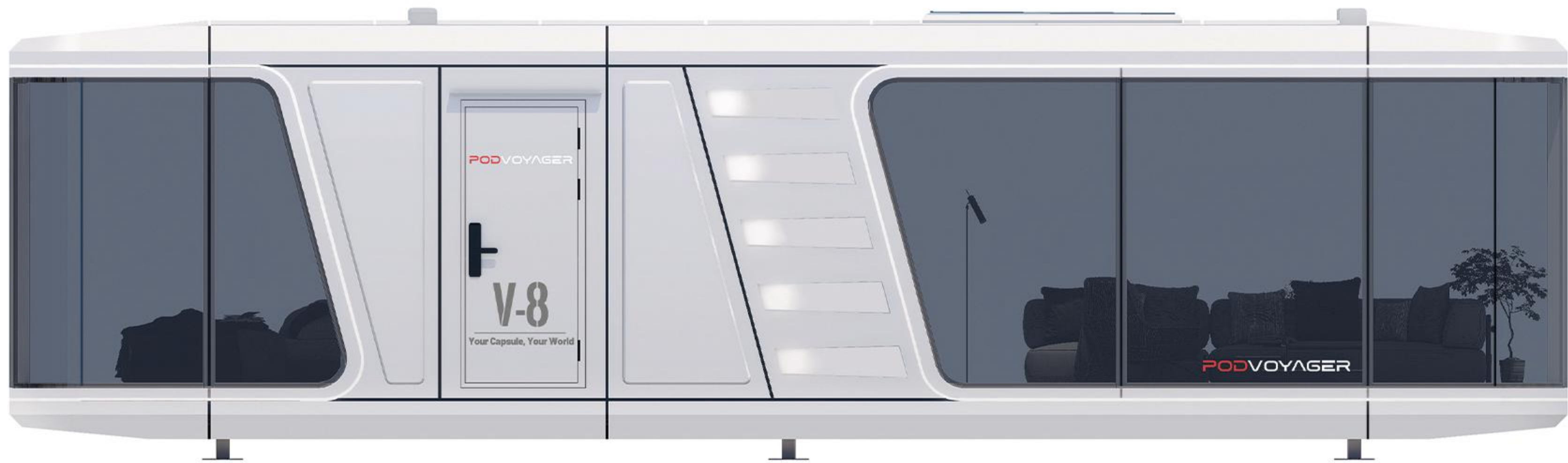

Domestic Version

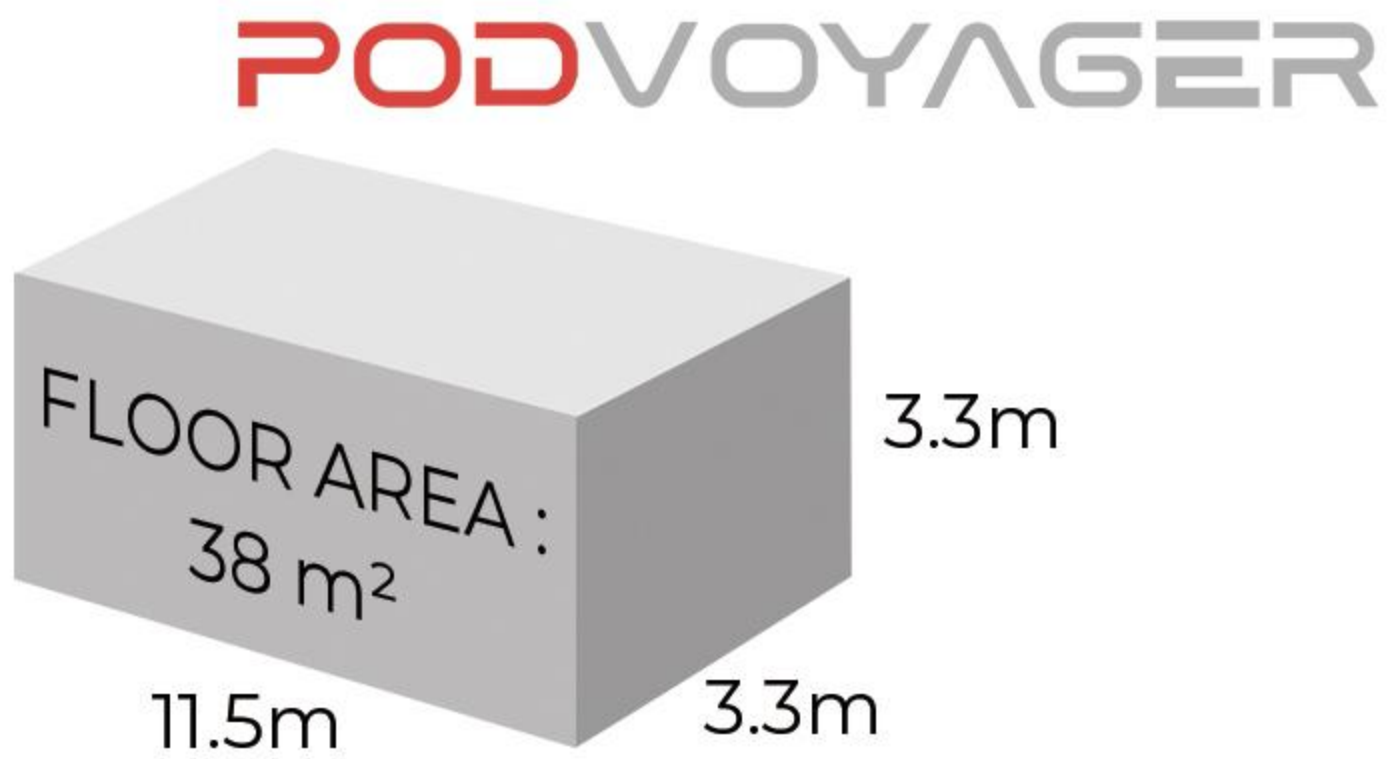
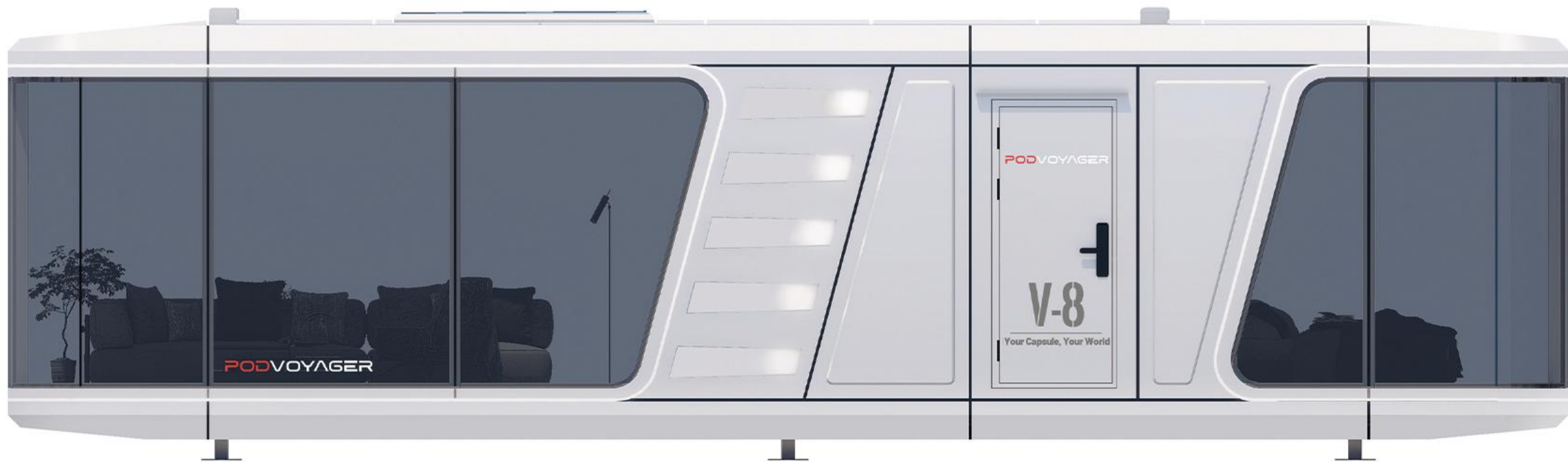

V-8

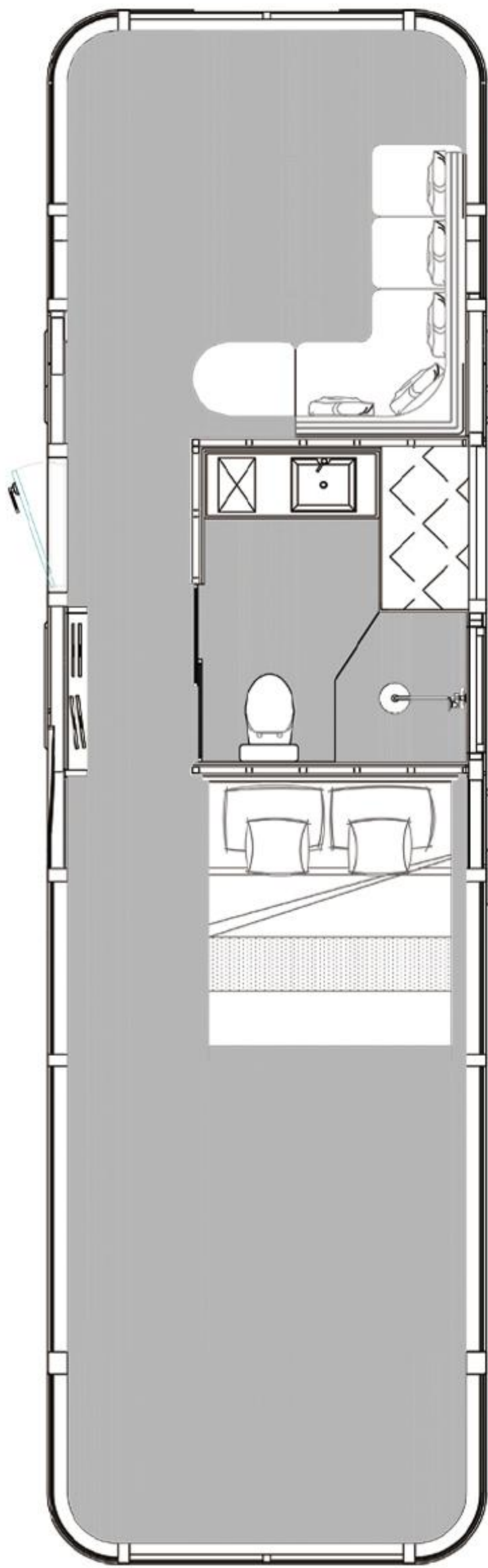

<b>MAIN STRUCTURE:</b>	Thickened Steel Frame, Aluminum Exterior Panels, Polyurethane Insulation Layer, Panoramic 6+12+6 Glass Wall Curtain , Aluminum Doors and Windows, Intelligent Access Control, Supporting Tubes.
<b>INTERNAL STRUCTURE:</b>	Aluminum Wall Panel, Waterproof Composite Wood Floor, Indoor and Outdoor Multi-Color Warm Light, Electric Curtain, Large Skylight, Whole-House Intelligent Control System, Branded Socket Panel.
<b>SANITARY WARE:</b>	Glass Side Sliding Door, Smart Toilet, Water Heater, Shower, Branded Basin, Branded Faucet.
<b>MAIN EQUIPMENT:</b>	Gree Central Air Conditioner, Water Heater, Multi-Function Integrated Bathroom Heater With Ventilation and Heating.
<b>MATCHING:</b>	Electric Floor Heating, Water Pipe Antifreeze, Projector, Fire and Smoke Alarm, Starry Roof.



PODVOYAGER

# V-7B

## AQUARIUS SERIES

Export Version



Domestic Version

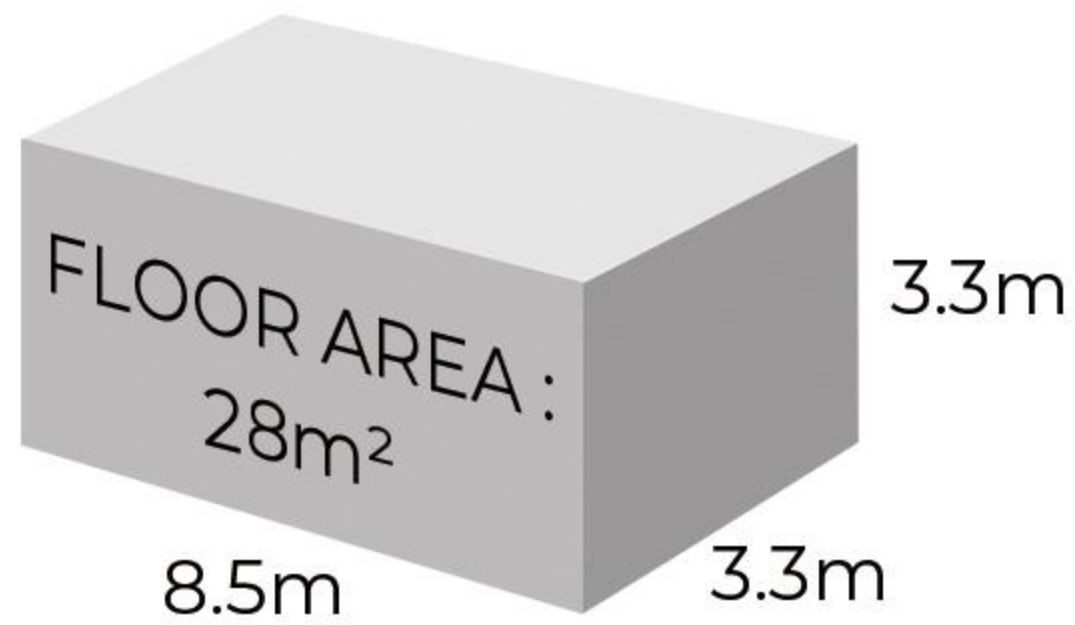

V-7B



MAIN STRUCTURE:	Thickened Steel Frame, Aluminum Exterior Panels, Polyurethane Insulation Layer, Panoramic 6+12+6 Glass Wall Curtain , Aluminum Doors and Windows, Intelligent Access Control, Supporting Tubes.
INTERNAL STRUCTURE:	Aluminum Wall Panel, Waterproof Composite Wood Floor, Indoor and Outdoor Multi-Color Warm Light, Electric Curtain, Large Skylight, Whole-House Intelligent Control System, Branded Socket Panel.
SANITARY WARE:	Glass Side Sliding Door, Smart Toilet, Water Heater, Shower, Branded Basin, Branded Faucet.
MAIN EQUIPMENT:	Gree Central Air Conditioner, Water Heater, Multi-Function Integrated Bathroom Heater With Ventilation and Heating.
MATCHING:	Electric Floor Heating, Water Pipe Antifreeze, Projector, Fire and Smoke Alarm, Starry Roof.



# V-7

## AQUARIUS SERIES

Export Version



Domestic Version



PODVOYAGER

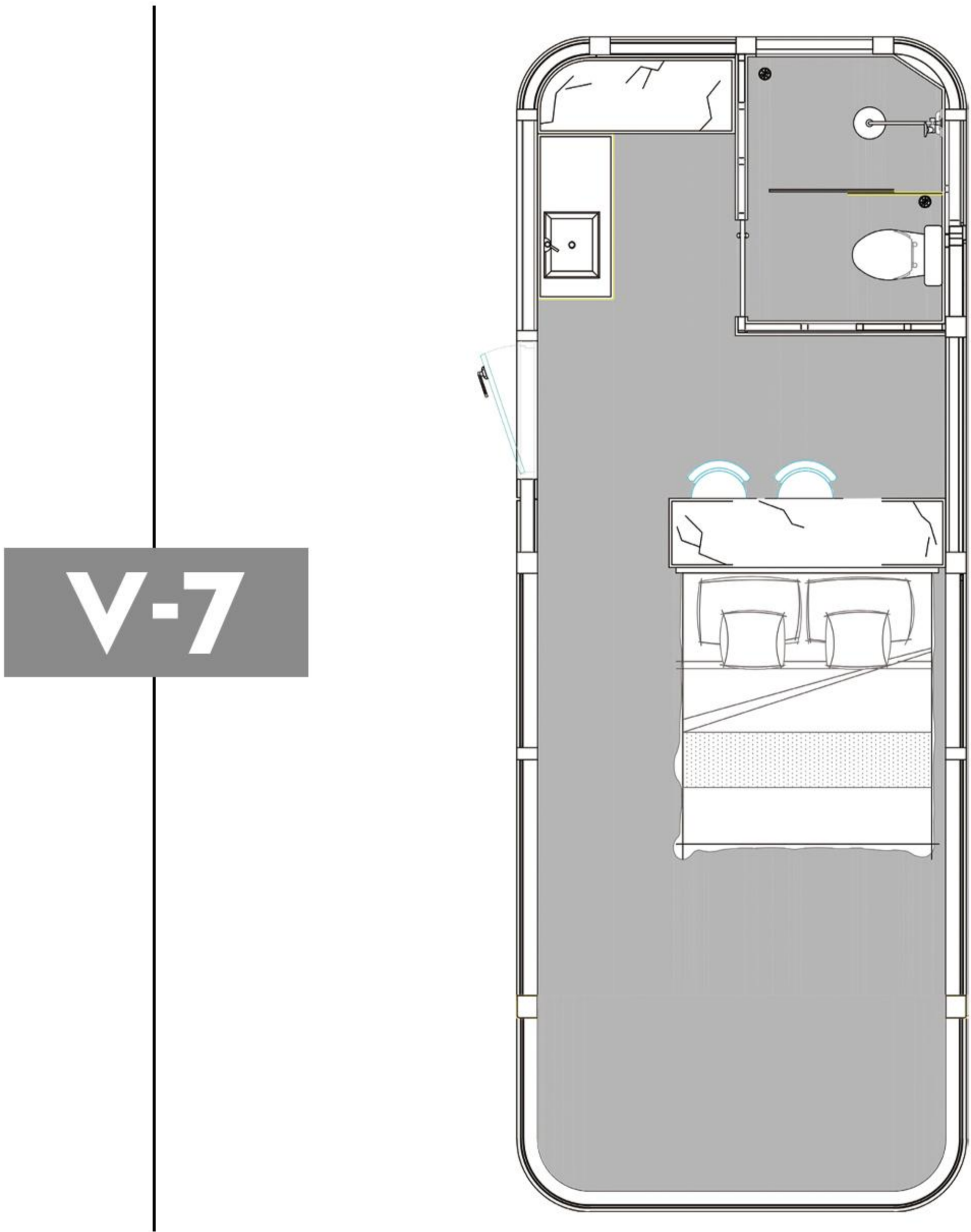
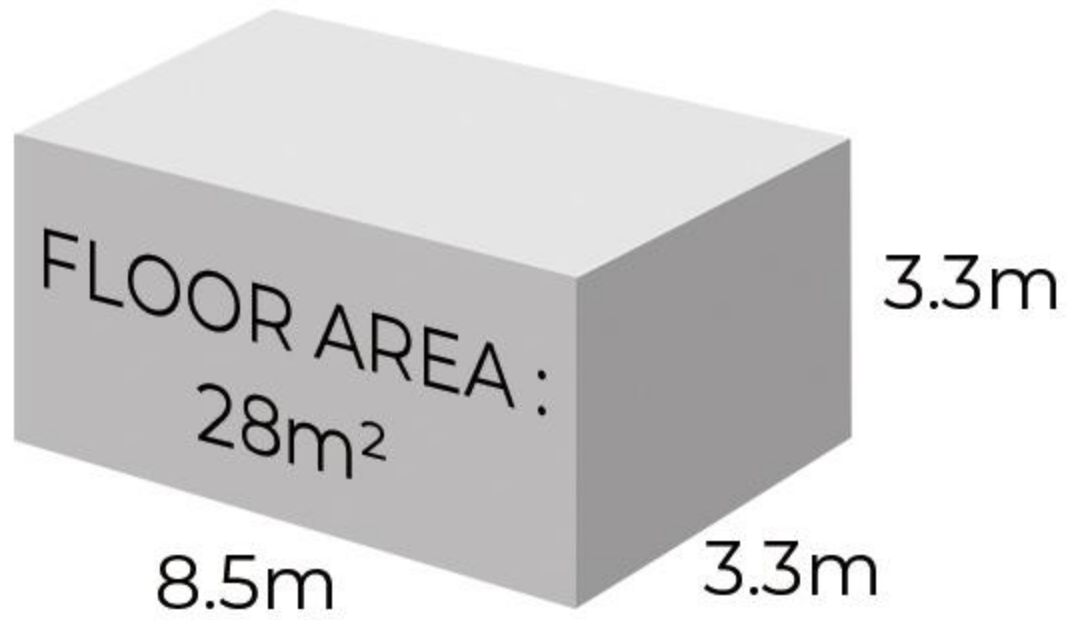

MAIN STRUCTURE:	Thickened Steel Frame, Aluminum Exterior Panels, Polyurethane Insulation Layer, Panoramic 6+12+6 Glass Wall Curtain , Aluminum Doors and Windows, Intelligent Access Control, Supporting Tubes.
INTERNAL STRUCTURE:	Aluminum Wall Panel, Waterproof Composite Wood Floor, Indoor and Outdoor Multi-Color Warm Light, Electric Curtain, Large Skylight, Whole-House Intelligent Control System, Branded Socket Panel.
SANITARY WARE:	Glass Side Sliding Door, Smart Toilet, Water Heater, Shower, Branded Basin, Branded Faucet.
MAIN EQUIPMENT:	Gree Central Air Conditioner, Water Heater, Multi-Function Integrated Bathroom Heater With Ventilation and Heating.
MATCHING:	Electric Floor Heating, Water Pipe Antifreeze, Projector, Fire and Smoke Alarm, Starry Roof.



PODVOYAGER

# V-3

## AQUARIUS SERIES

Export Version



Domestic Version

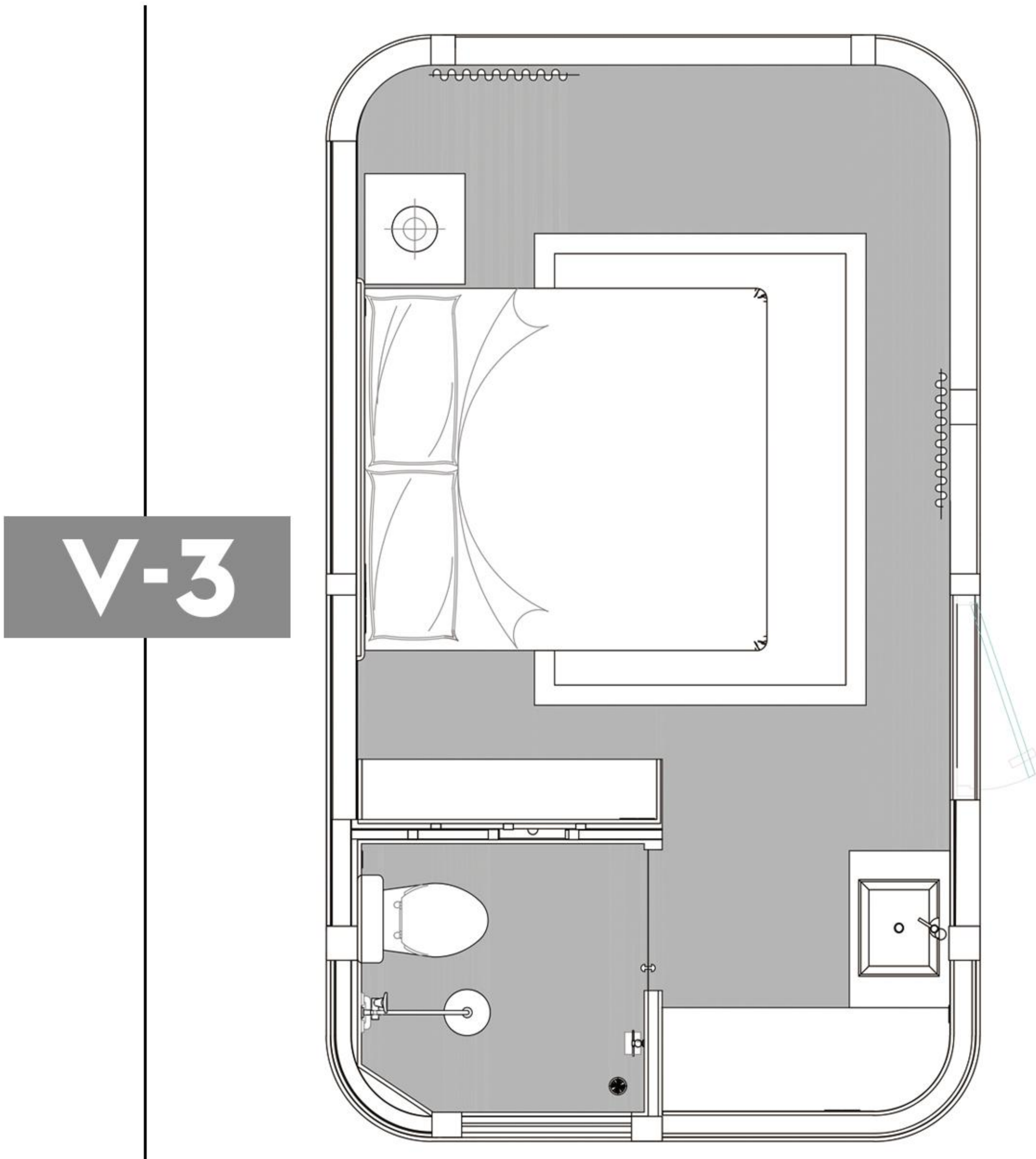
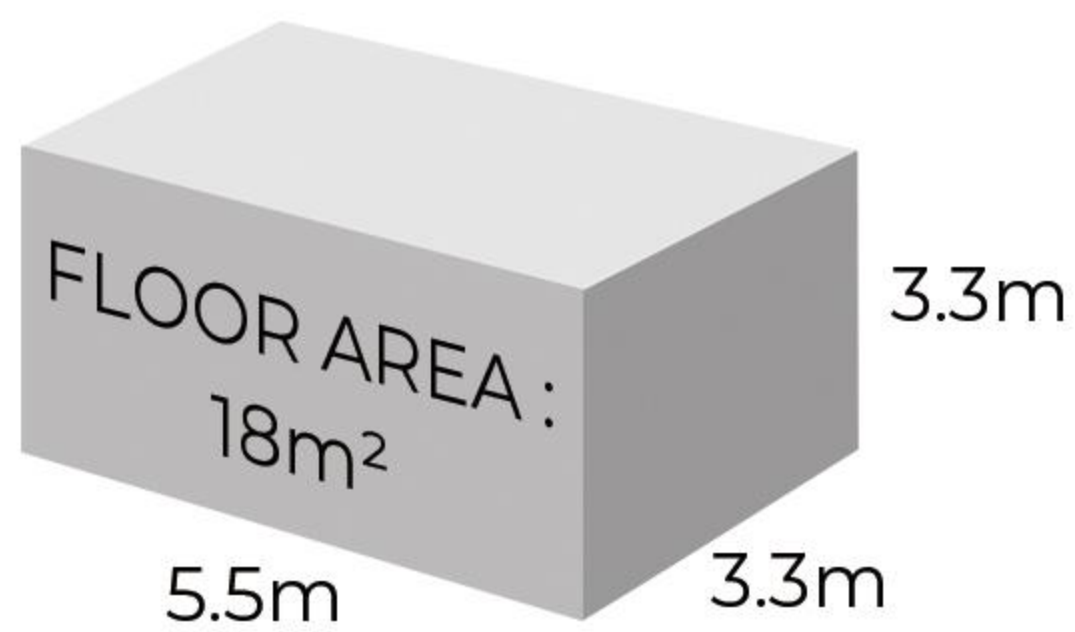

MAIN STRUCTURE:	Thickened Steel Frame, Aluminum Exterior Panels, Polyurethane Insulation Layer, Panoramic 6+12+6 Glass Wall Curtain , Aluminum Doors and Windows, Intelligent Access Control, Supporting Tubes.
INTERNAL STRUCTURE:	Aluminum Wall Panel, Waterproof Composite Wood Floor, Indoor and Outdoor Multi-Color Warm Light, Electric Curtain, Large Skylight, Whole-House Intelligent Control System, Branded Socket Panel.
SANITARY WARE:	Glass Side Sliding Door, Smart Toilet, Water Heater, Shower, Branded Basin, Branded Faucet.
MAIN EQUIPMENT:	Gree Central Air Conditioner, Water Heater, Multi-Function Integrated Bathroom Heater With Ventilation and Heating.
MATCHING:	Electric Floor Heating, Water Pipe Antifreeze, Projector, Fire and Smoke Alarm, Starry Roof.



# X-8B

## PISCES SERIES

Export Version

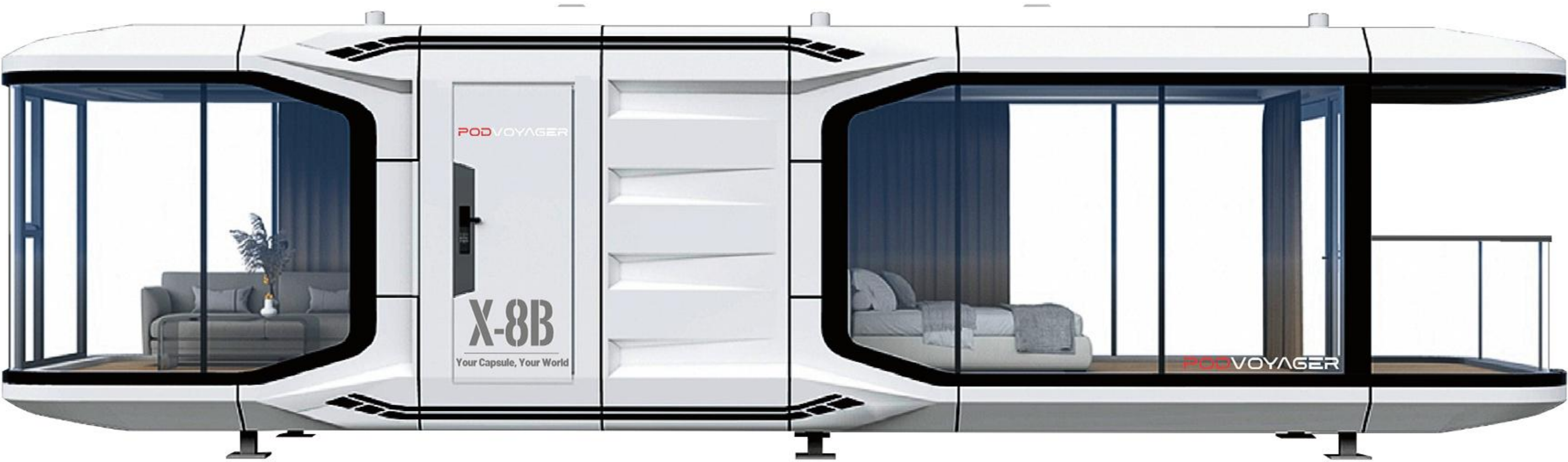

Domestic Version



PODVOYAGER

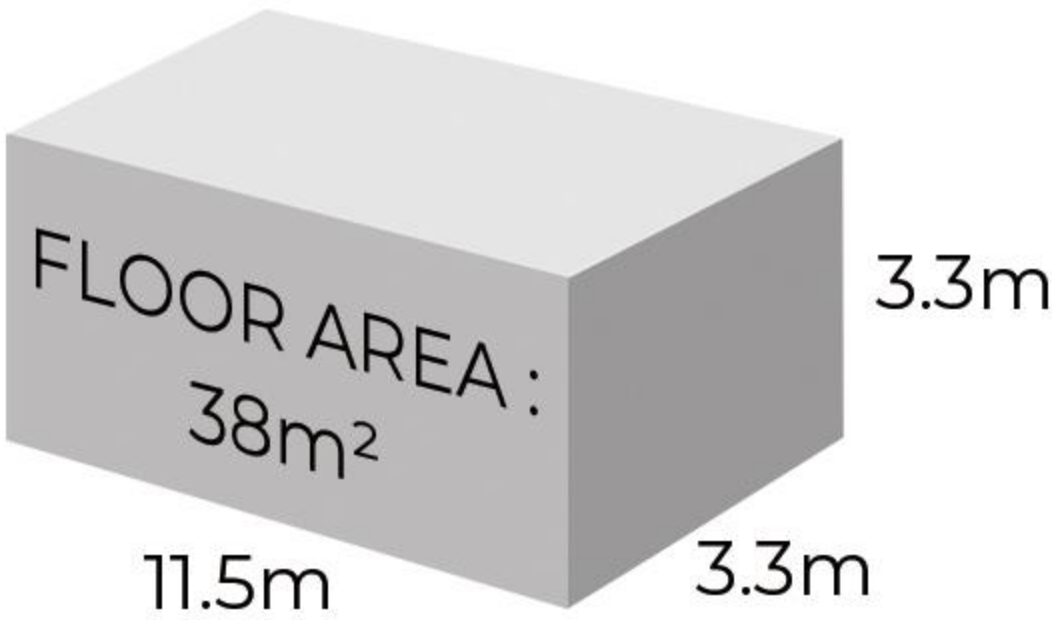

X-8B

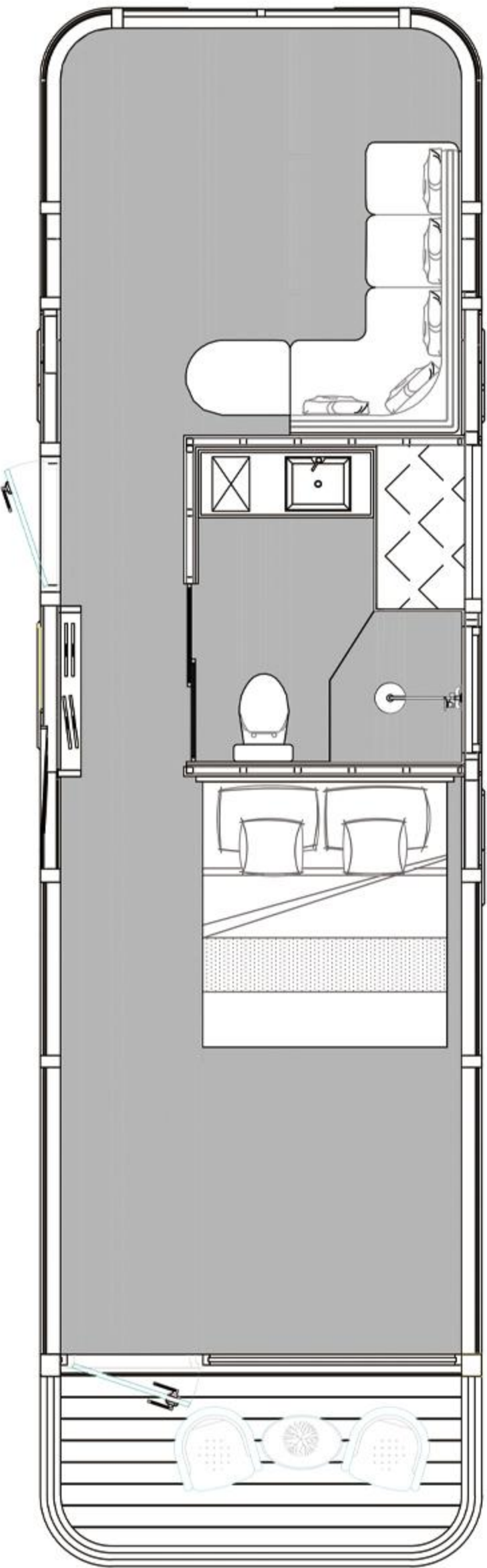

MAIN STRUCTURE:	Thickened Steel Frame, Aluminum Exterior Panels, Polyurethane Insulation Layer, Panoramic 6+12+6 Glass Wall Curtain , Aluminum Doors and Windows, Intelligent Access Control, Supporting Tubes.
INTERNAL STRUCTURE:	Aluminum Wall Panel, Waterproof Composite Wood Floor, Indoor and Outdoor Multi-Color Warm Light, Electric Curtain, Large Skylight, Whole-House Intelligent Control System, Branded Socket Panel.
SANITARY WARE:	Glass Side Sliding Door, Smart Toilet, Water Heater, Shower, Branded Basin, Branded Faucet.
MAIN EQUIPMENT:	Gree Central Air Conditioner, Water Heater, Multi-Function Integrated Bathroom Heater With Ventilation and Heating.
MATCHING:	Electric Floor Heating, Water Pipe Antifreeze, Projector, Fire and Smoke Alarm, Starry Roof.



# X-8

## PISCES SERIES

Export Version



Domestic Version

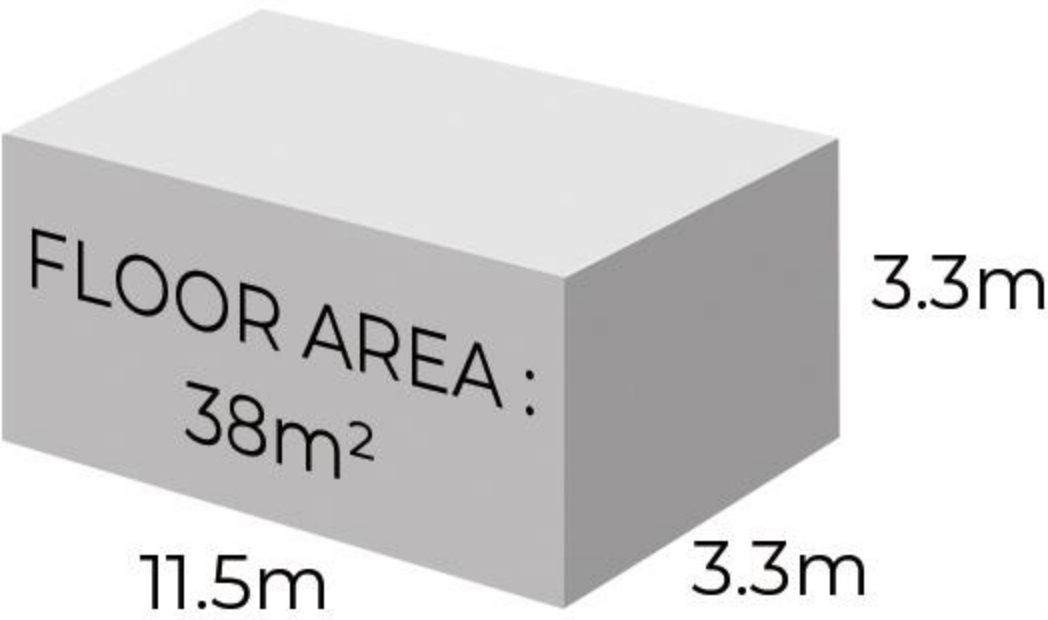

X-8

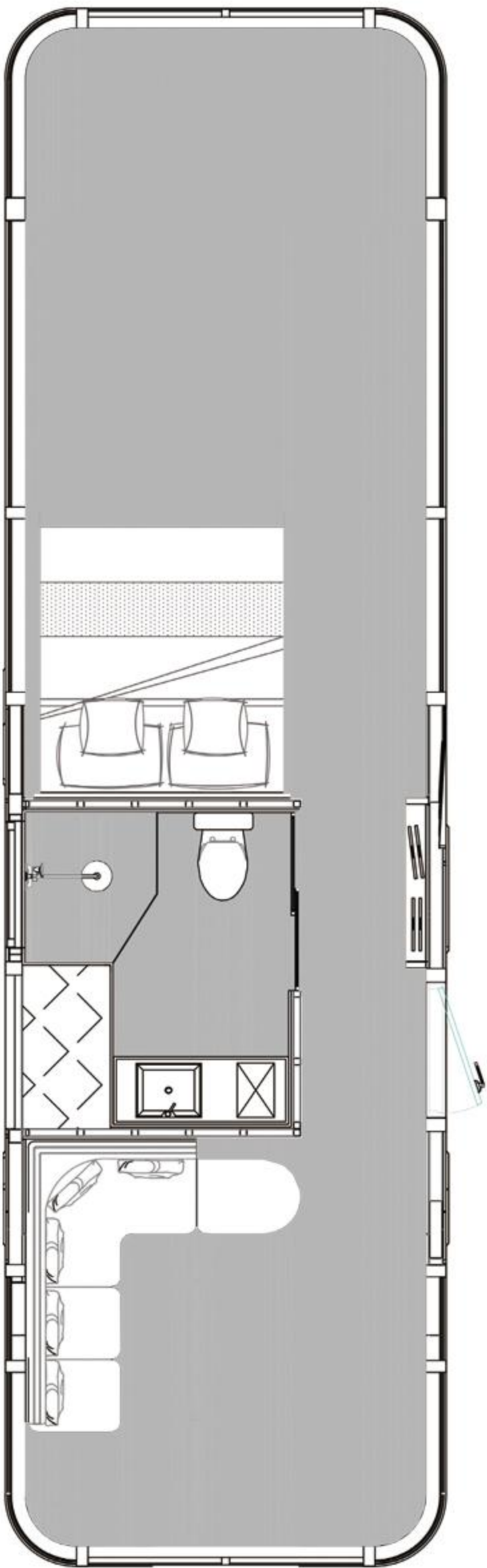

MAIN STRUCTURE:	Thickened Steel Frame, Aluminum Exterior Panels, Polyurethane Insulation Layer, Panoramic 6+12+6 Glass Wall Curtain , Aluminum Doors and Windows, Intelligent Access Control, Supporting Tubes.
INTERNAL STRUCTURE:	Aluminum Wall Panel, Waterproof Composite Wood Floor, Indoor and Outdoor Multi-Color Warm Light, Electric Curtain, Large Skylight, Whole-House Intelligent Control System, Branded Socket Panel.
SANITARY WARE:	Glass Side Sliding Door, Smart Toilet, Water Heater, Shower, Branded Basin, Branded Faucet.
MAIN EQUIPMENT:	Gree Central Air Conditioner, Water Heater, Multi-Function Integrated Bathroom Heater With Ventilation and Heating.
MATCHING:	Electric Floor Heating, Water Pipe Antifreeze, Projector, Fire and Smoke Alarm, Starry Roof.



# X-7B

## PISCES SERIES

Export Version



Domestic Version



PODVOYAGER

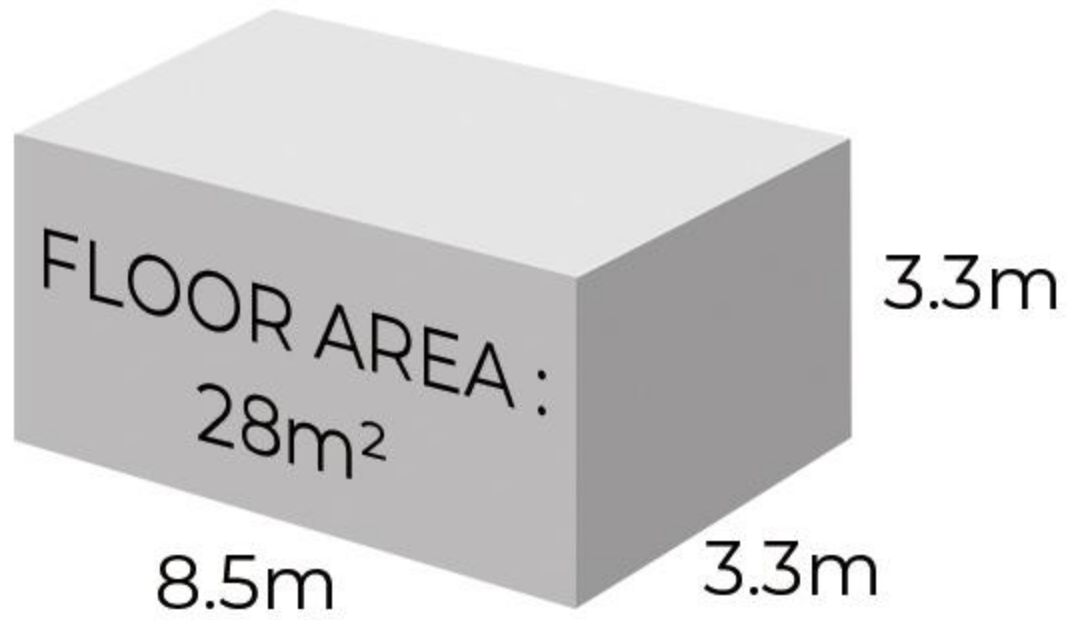

X-7B



MAIN STRUCTURE:	Thickened Steel Frame, Aluminum Exterior Panels, Polyurethane Insulation Layer, Panoramic 6+12+6 Glass Wall Curtain , Aluminum Doors and Windows, Intelligent Access Control, Supporting Tubes.
INTERNAL STRUCTURE:	Aluminum Wall Panel, Waterproof Composite Wood Floor, Indoor and Outdoor Multi-Color Warm Light, Electric Curtain, Large Skylight, Whole-House Intelligent Control System, Branded Socket Panel.
SANITARY WARE:	Glass Side Sliding Door, Smart Toilet, Water Heater, Shower, Branded Basin, Branded Faucet.
MAIN EQUIPMENT:	Gree Central Air Conditioner, Water Heater, Multi-Function Integrated Bathroom Heater With Ventilation and Heating.
MATCHING:	Electric Floor Heating, Water Pipe Antifreeze, Projector, Fire and Smoke Alarm, Starry Roof.



# X-7

## PISCES SERIES

Export Version



Domestic Version

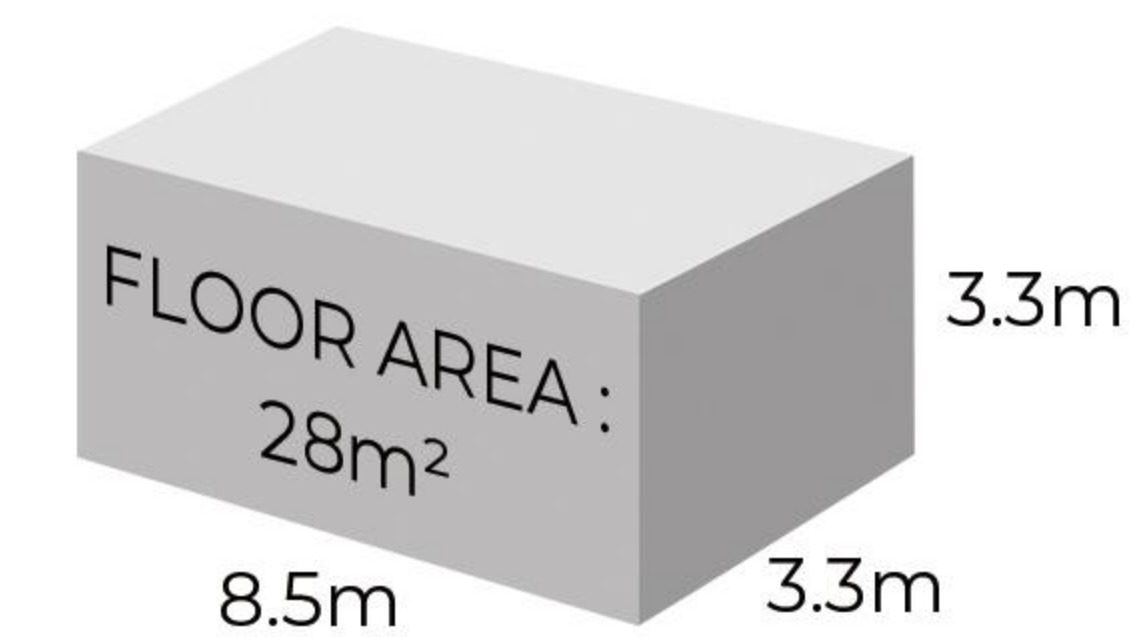

X-7

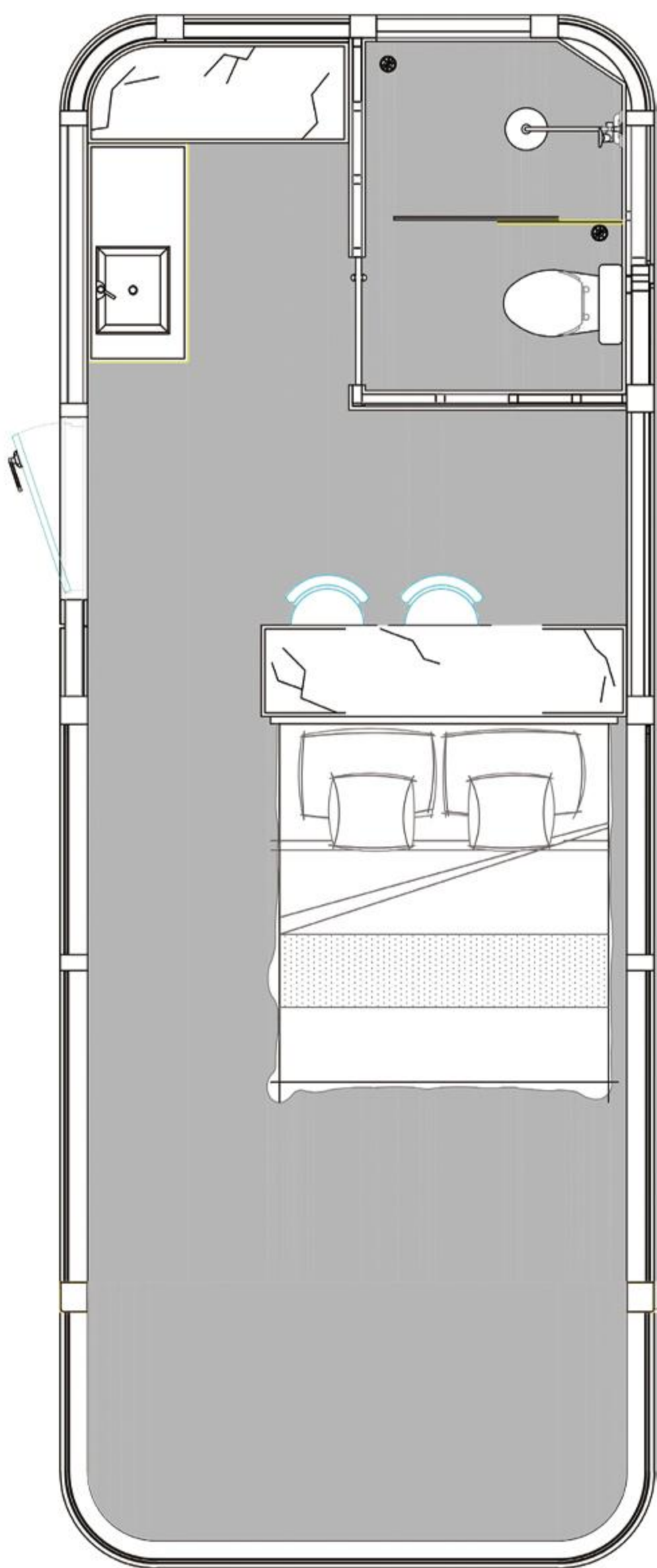

MAIN STRUCTURE:	Thickened Steel Frame, Aluminum Exterior Panels, Polyurethane Insulation Layer, Panoramic 6+12+6 Glass Wall Curtain , Aluminum Doors and Windows, Intelligent Access Control, Supporting Tubes.
INTERNAL STRUCTURE:	Aluminum Wall Panel, Waterproof Composite Wood Floor, Indoor and Outdoor Multi-Color Warm Light, Electric Curtain, Large Skylight, Whole-House Intelligent Control System, Branded Socket Panel.
SANITARY WARE:	Glass Side Sliding Door, Smart Toilet, Water Heater, Shower, Branded Basin, Branded Faucet.
MAIN EQUIPMENT:	Gree Central Air Conditioner, Water Heater, Multi-Function Integrated Bathroom Heater With Ventilation and Heating.
MATCHING:	Electric Floor Heating, Water Pipe Antifreeze, Projector, Fire and Smoke Alarm, Starry Roof.



# T-7

## ARIES SERIES

Export Version



Domestic Version

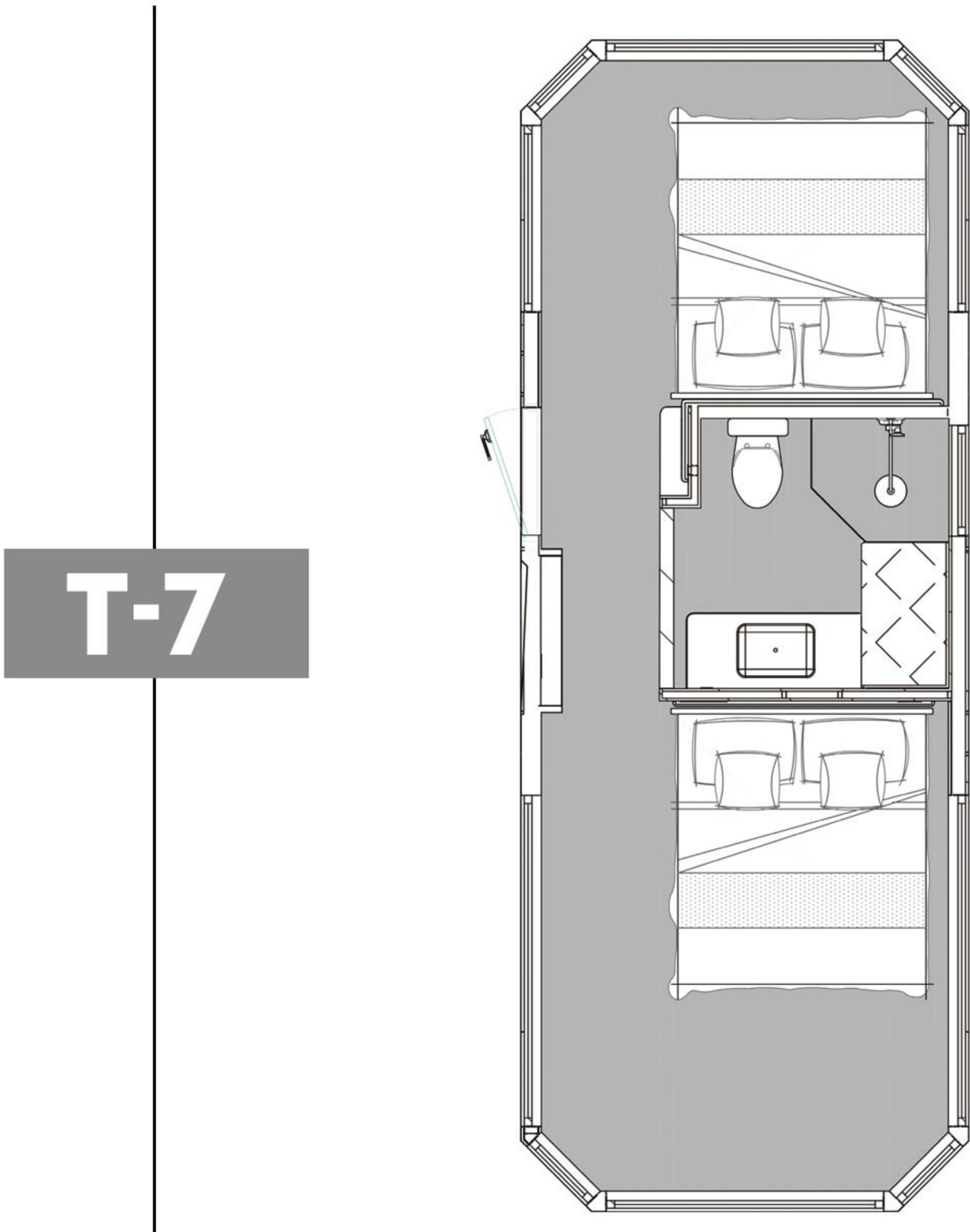
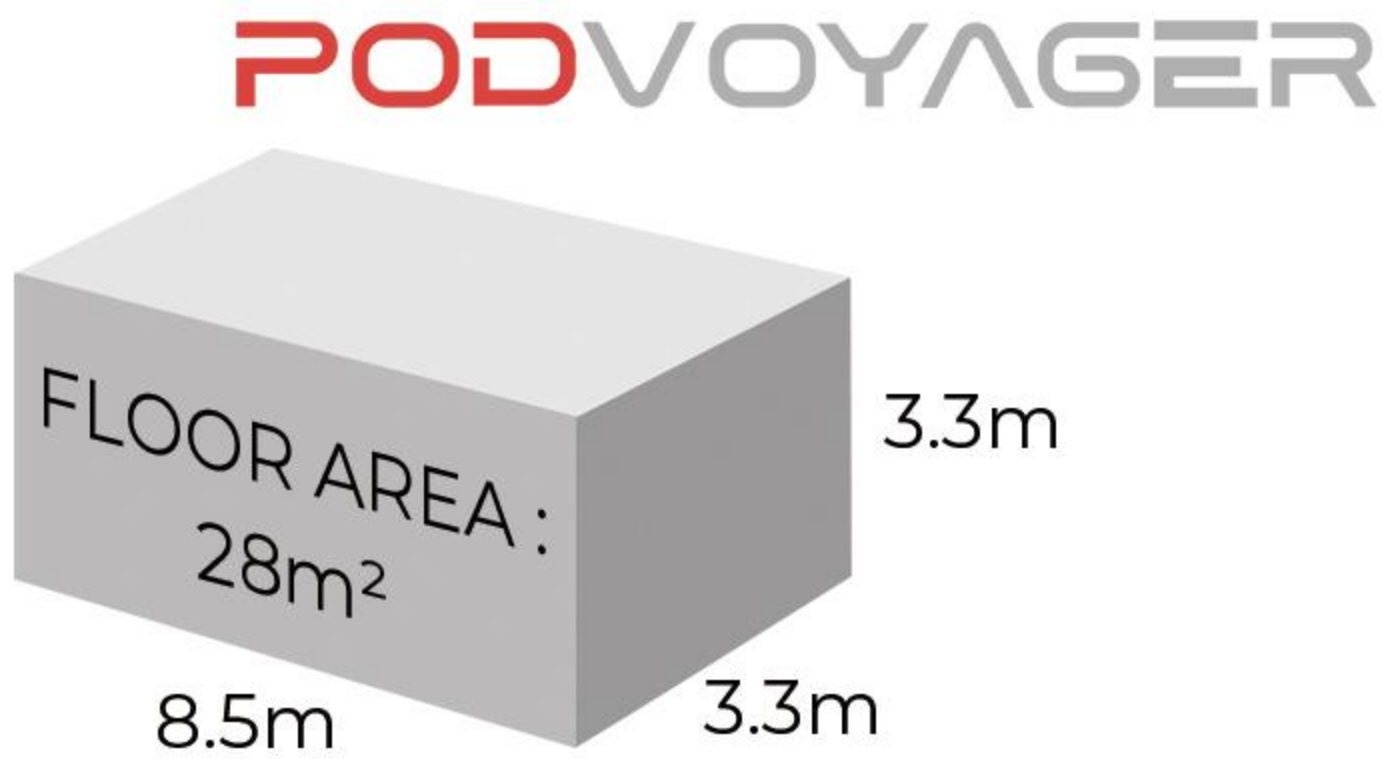

<b>MAIN STRUCTURE:</b>	Thickened Steel Frame, Aluminum Exterior Panels, Polyurethane Insulation Layer, Panoramic 6+12+6 Glass Wall Curtain , Aluminum Doors and Windows, Intelligent Access Control, Supporting Tubes.
<b>INTERNAL STRUCTURE:</b>	Aluminum Wall Panel, Waterproof Composite Wood Floor, Indoor and Outdoor Multi-Color Warm Light, Electric Curtain, Large Skylight, Whole-House Intelligent Control System, Branded Socket Panel.
<b>SANITARY WARE:</b>	Glass Side Sliding Door, Smart Toilet, Water Heater, Shower, Branded Basin, Branded Faucet.
<b>MAIN EQUIPMENT:</b>	Gree Central Air Conditioner, Water Heater, Multi-Function Integrated Bathroom Heater With Ventilation and Heating.
<b>MATCHING:</b>	Electric Floor Heating, Water Pipe Antifreeze, Projector, Fire and Smoke Alarm, Starry Roof.



# C-8

## TAURUS SERIES

Export Version

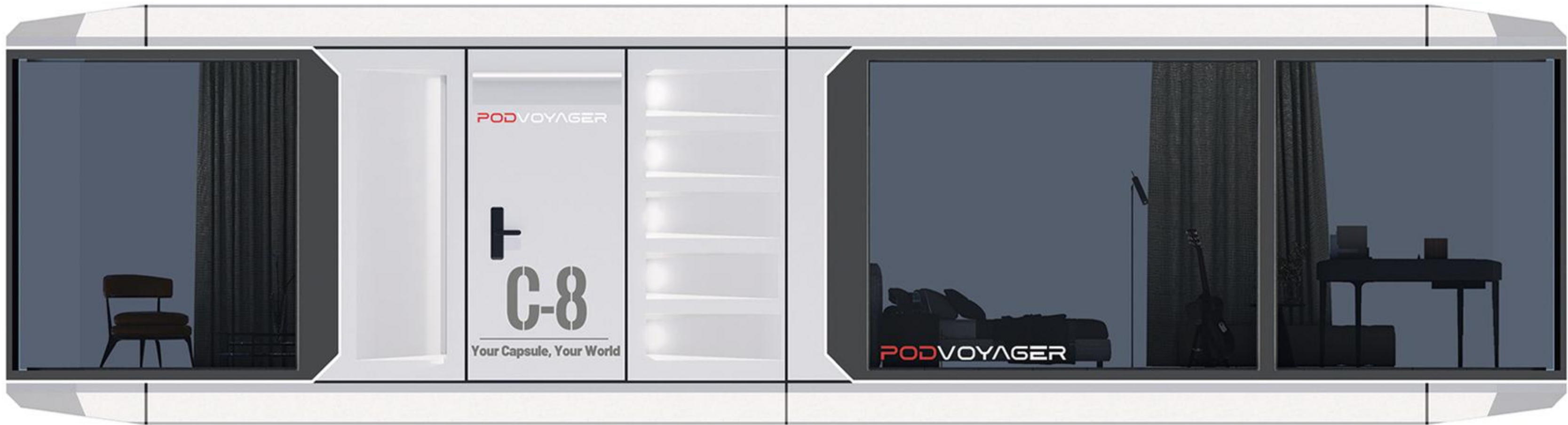

Domestic Version

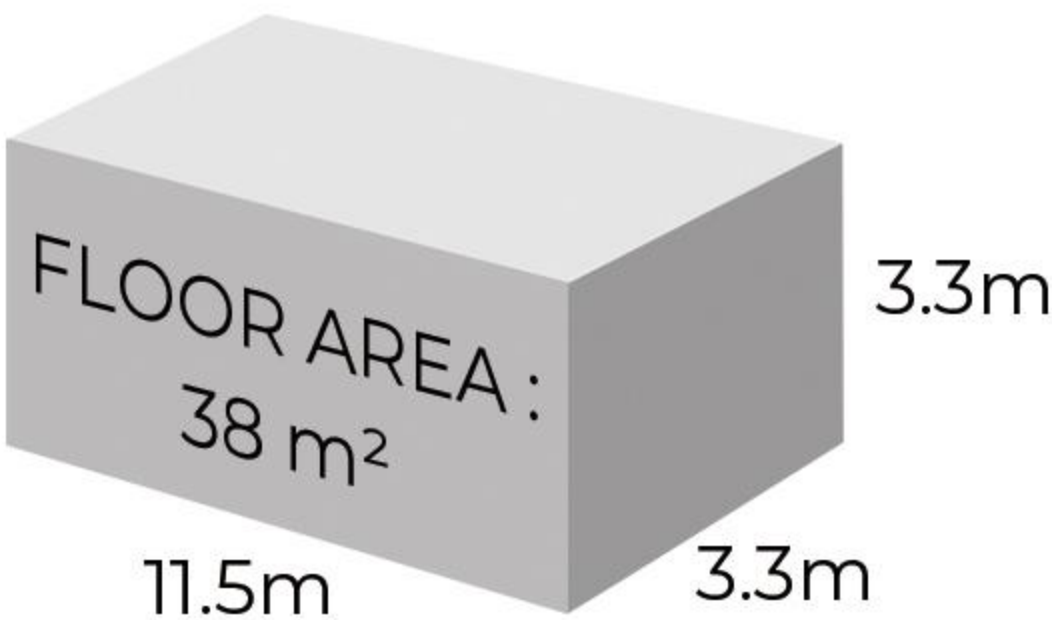
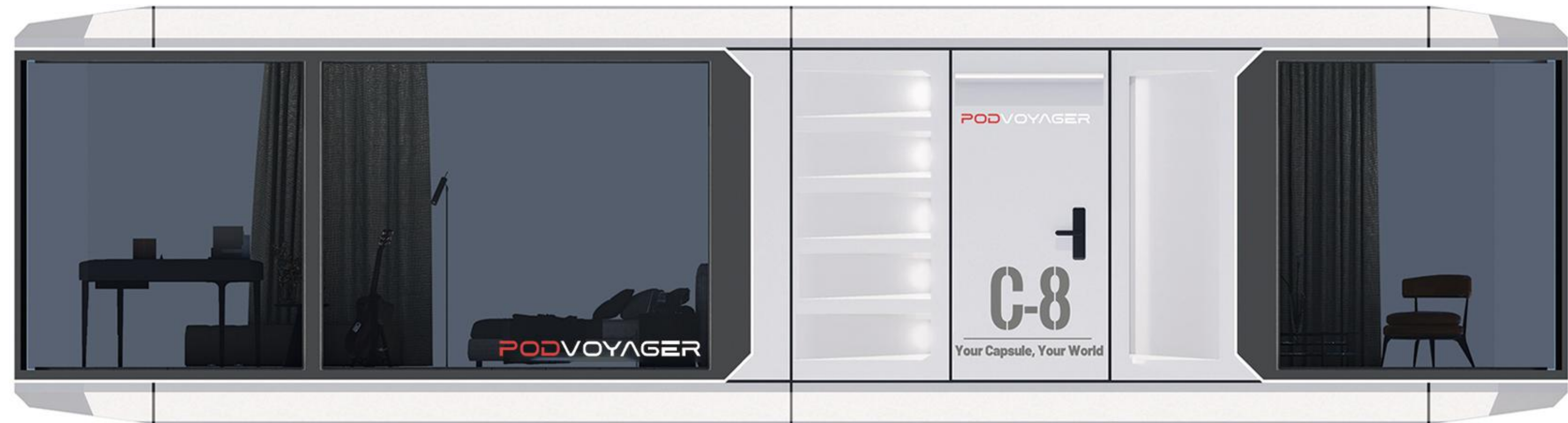

C-8

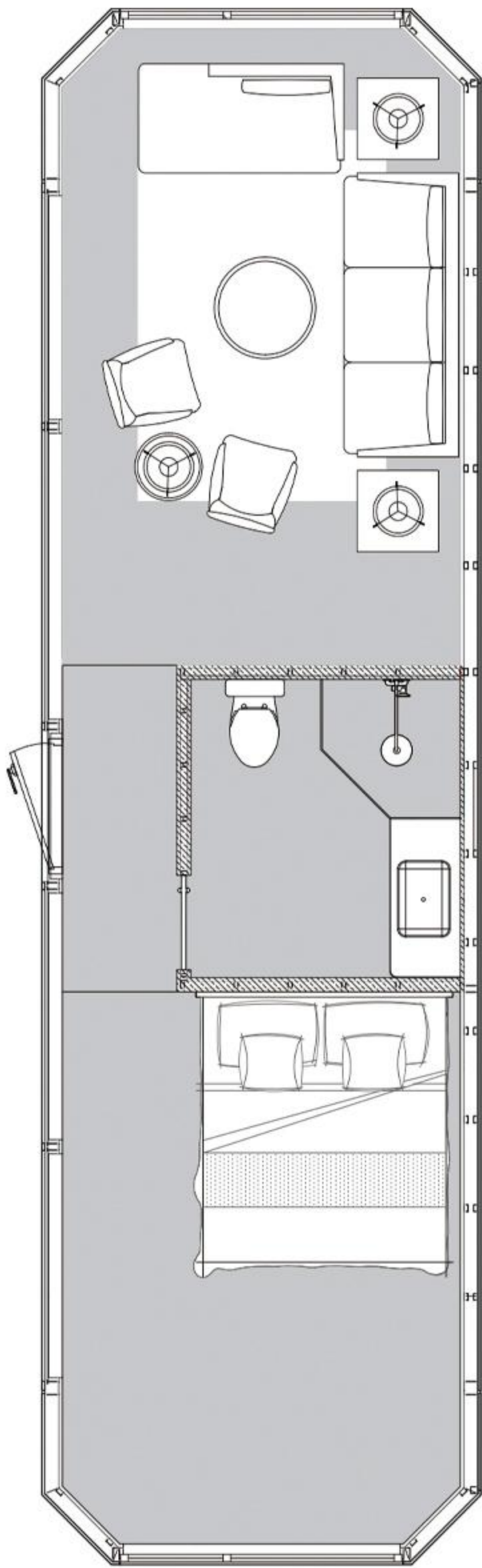

MAIN STRUCTURE:	Thickened Steel Frame, Aluminum Exterior Panels, Polyurethane Insulation Layer, Panoramic 6+12+6 Glass Wall Curtain , Aluminum Doors and Windows, Intelligent Access Control, Supporting Tubes.
INTERNAL STRUCTURE:	Aluminum Wall Panel, Waterproof Composite Wood Floor, Indoor and Outdoor Multi-Color Warm Light, Electric Curtain, Large Skylight, Whole-House Intelligent Control System, Branded Socket Panel.
SANITARY WARE:	Glass Side Sliding Door, Smart Toilet, Water Heater, Shower, Branded Basin, Branded Faucet.
MAIN EQUIPMENT:	Gree Central Air Conditioner, Water Heater, Multi-Function Integrated Bathroom Heater With Ventilation and Heating.
MATCHING:	Electric Floor Heating, Water Pipe Antifreeze, Projector, Fire and Smoke Alarm, Starry Roof.



# C-7

## TAURUS SERIES

PODVOYAGER

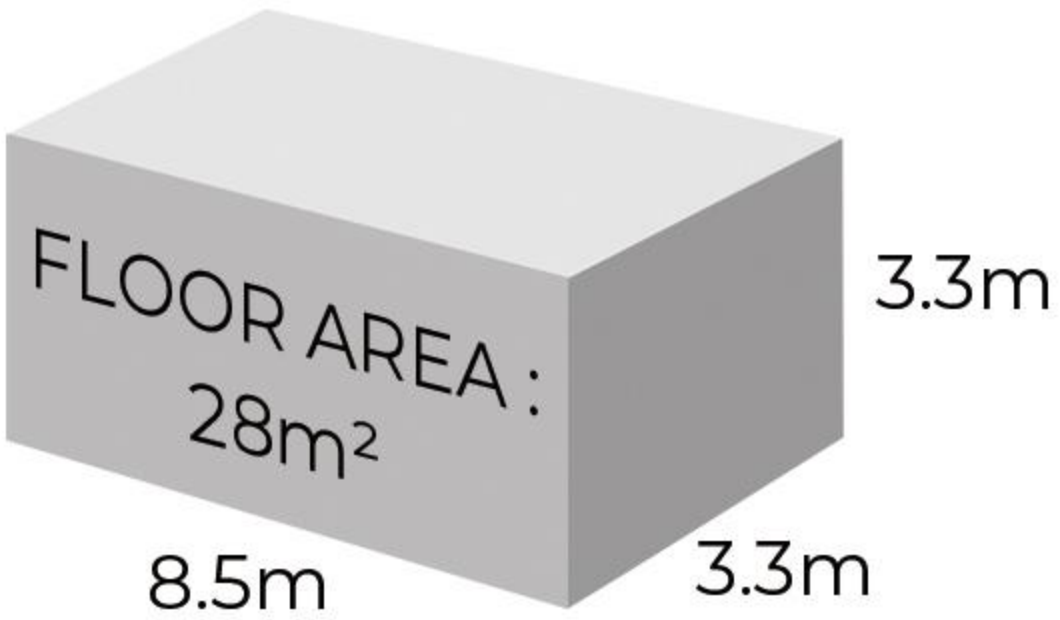

Export Version

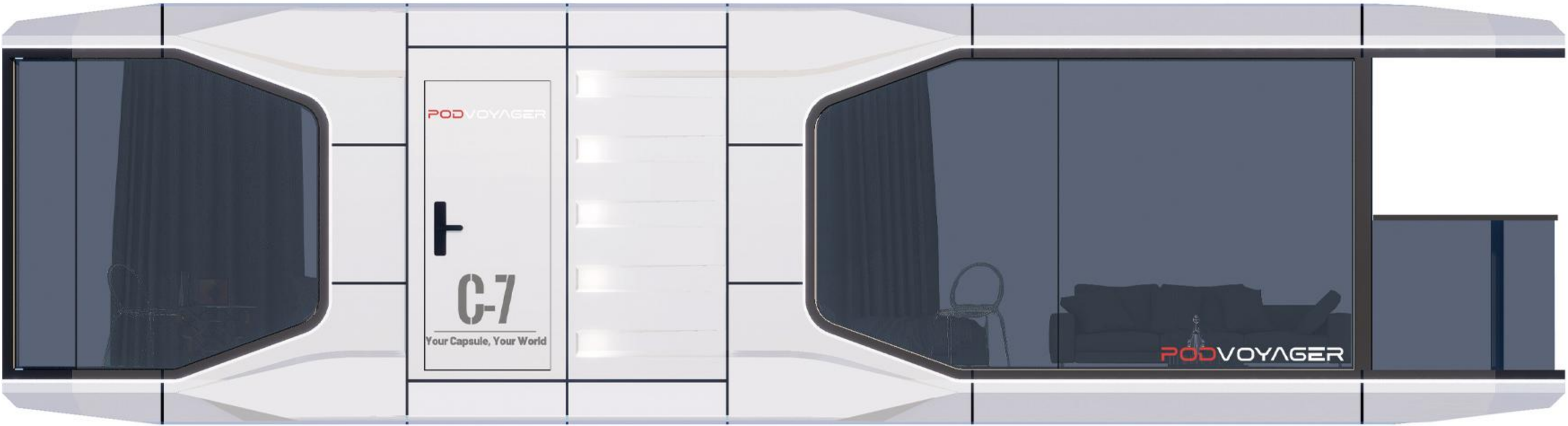

Domestic Version

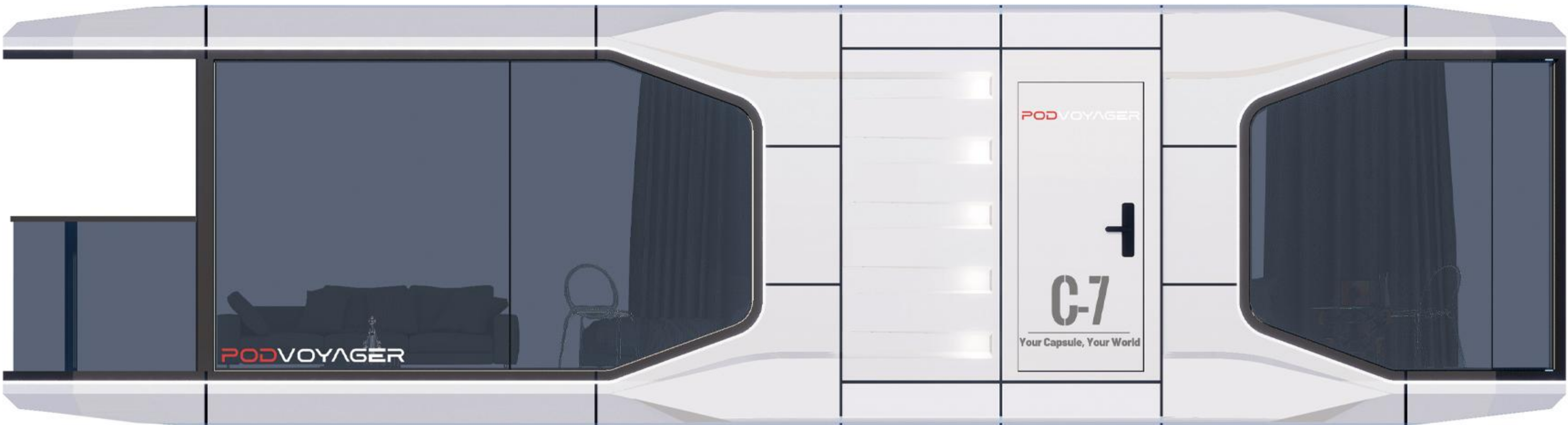

C-7

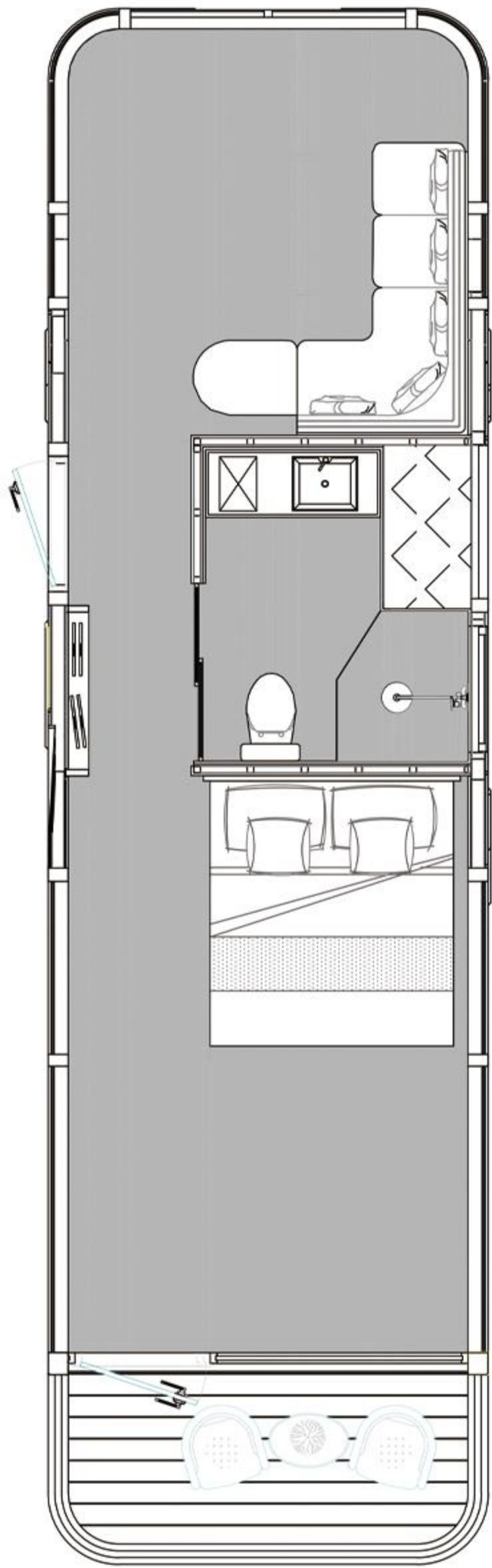

MAIN STRUCTURE:	Thickened Steel Frame, Aluminum Exterior Panels, Polyurethane Insulation Layer, Panoramic 6+12+6 Glass Wall Curtain , Aluminum Doors and Windows, Intelligent Access Control, Supporting Tubes.
INTERNAL STRUCTURE:	Aluminum Wall Panel, Waterproof Composite Wood Floor, Indoor and Outdoor Multi-Color Warm Light, Electric Curtain, Large Skylight, Whole-House Intelligent Control System, Branded Socket Panel.
SANITARY WARE:	Glass Side Sliding Door, Smart Toilet, Water Heater, Shower, Branded Basin, Branded Faucet.
MAIN EQUIPMENT:	Gree Central Air Conditioner, Water Heater, Multi-Function Integrated Bathroom Heater With Ventilation and Heating.
MATCHING:	Electric Floor Heating, Water Pipe Antifreeze, Projector, Fire and Smoke Alarm, Starry Roof.



# A-8

## GEMINI SERIES

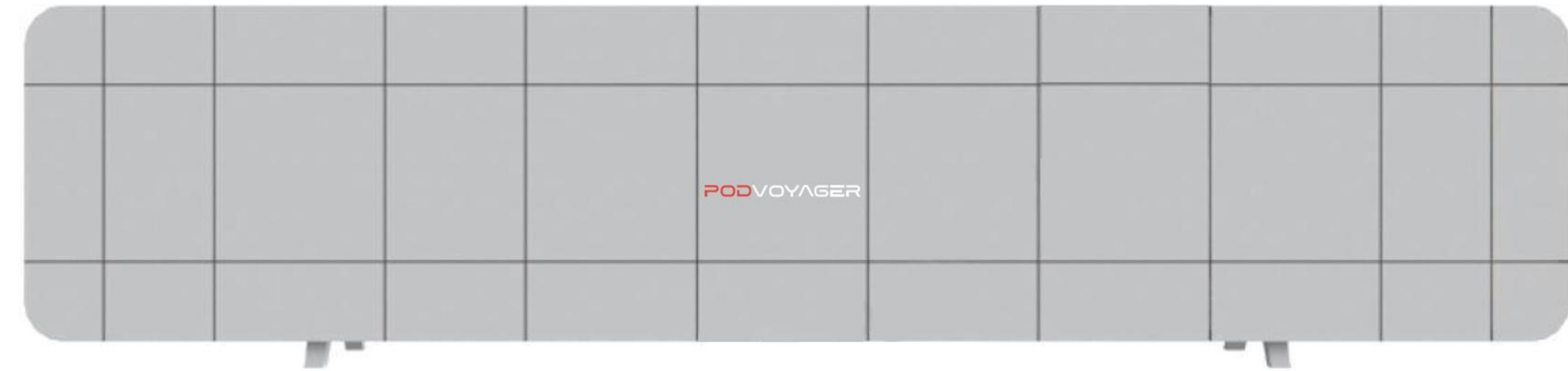
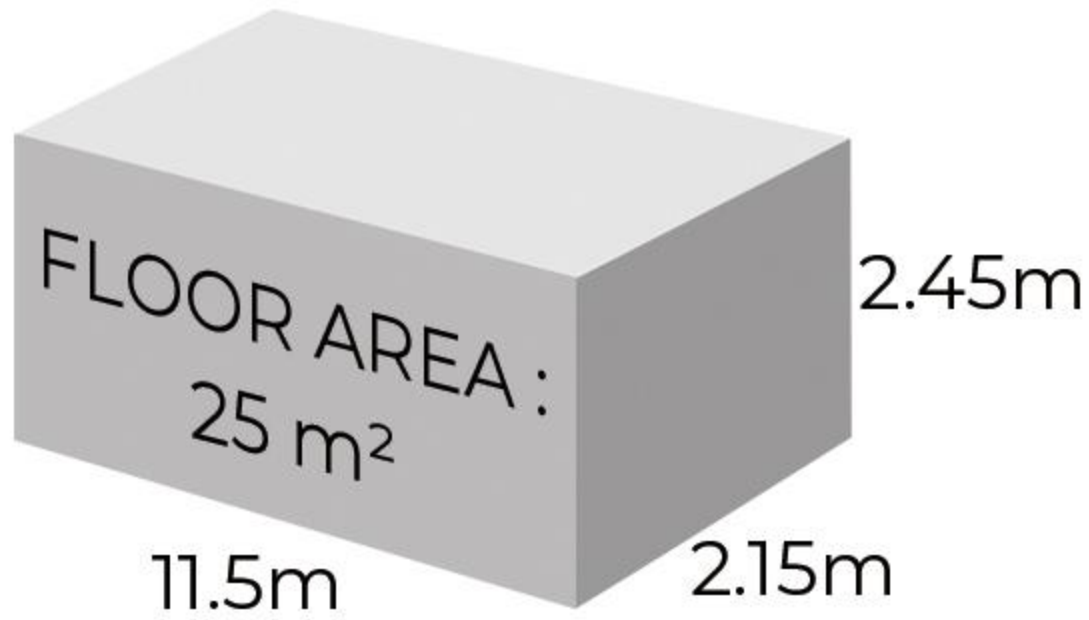

A-8

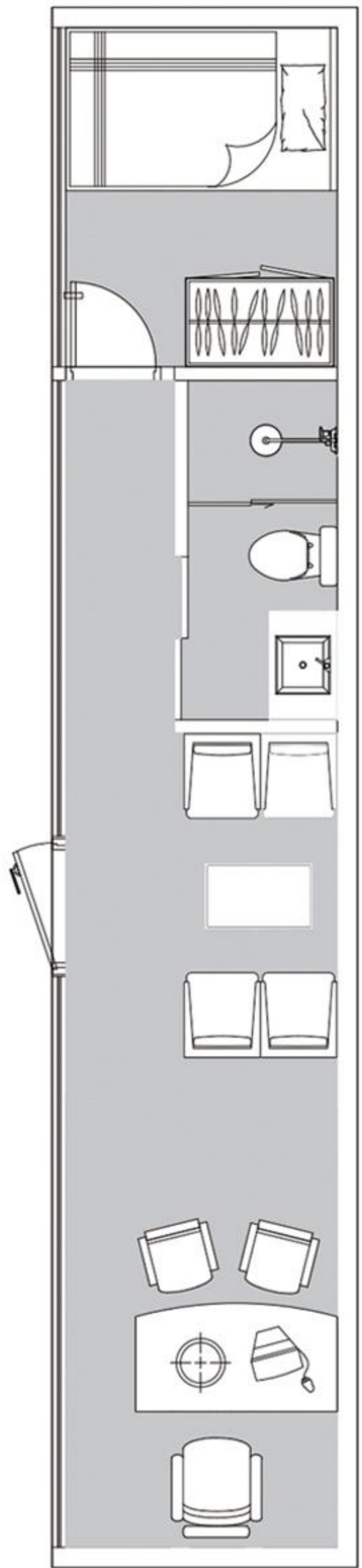

MAIN STRUCTURE:	Thickened Steel Frame, Aluminum Exterior Panels, Polyurethane Insulation Layer, Panoramic 6+12+6 Glass Wall Curtain , Aluminum Doors and Windows, Intelligent Access Control, Supporting Tubes.
INTERNAL STRUCTURE:	Aluminum Wall Panel, Waterproof Composite Wood Floor, Indoor and Outdoor Multi-Color Warm Light, Electric Curtain, Large Skylight, Whole-House Intelligent Control System, Branded Socket Panel.
SANITARY WARE:	Glass Side Sliding Door, Smart Toilet, Water Heater, Shower, Branded Basin, Branded Faucet.
MAIN EQUIPMENT:	Gree Central Air Conditioner, Water Heater, Multi-Function Integrated Bathroom Heater With Ventilation and Heating.
MATCHING:	Electric Floor Heating, Water Pipe Antifreeze, Projector, Fire and Smoke Alarm, Starry Roof.



**PRODUCT INTERIOR DECORATION**





COOPERATION PARTNER



# 01

## TRANSPORTATION METHOD

To ensure safe transportation, each cabin is carefully wrapped in protective materials and covered with a durable, waterproof tarpaulin. Then a crane would be used to lift the house to the truck for delivery.

# 02

## RECEIVING GOODS

After the goods arrive at the site, the customer needs to contact the local crane service. Our technical team can arrive at the site in advance for guidance. Lifting weight of 5 to 10 tons, it is recommended to use not less than 25 tons of crane loading and unloading.

### Notice

Before installing the product, the customer must complete the on-site engineering of water supply, electricity supply, sewage pipelines and load-bearing foundation in accordance with our company's product standard basic water and electricity drawings. Under the guidance of our technicians, we accurately positioned it at the designed installation point. After connecting water and electricity, we completed the water and electricity test and submitted it to the customer for acceptance.





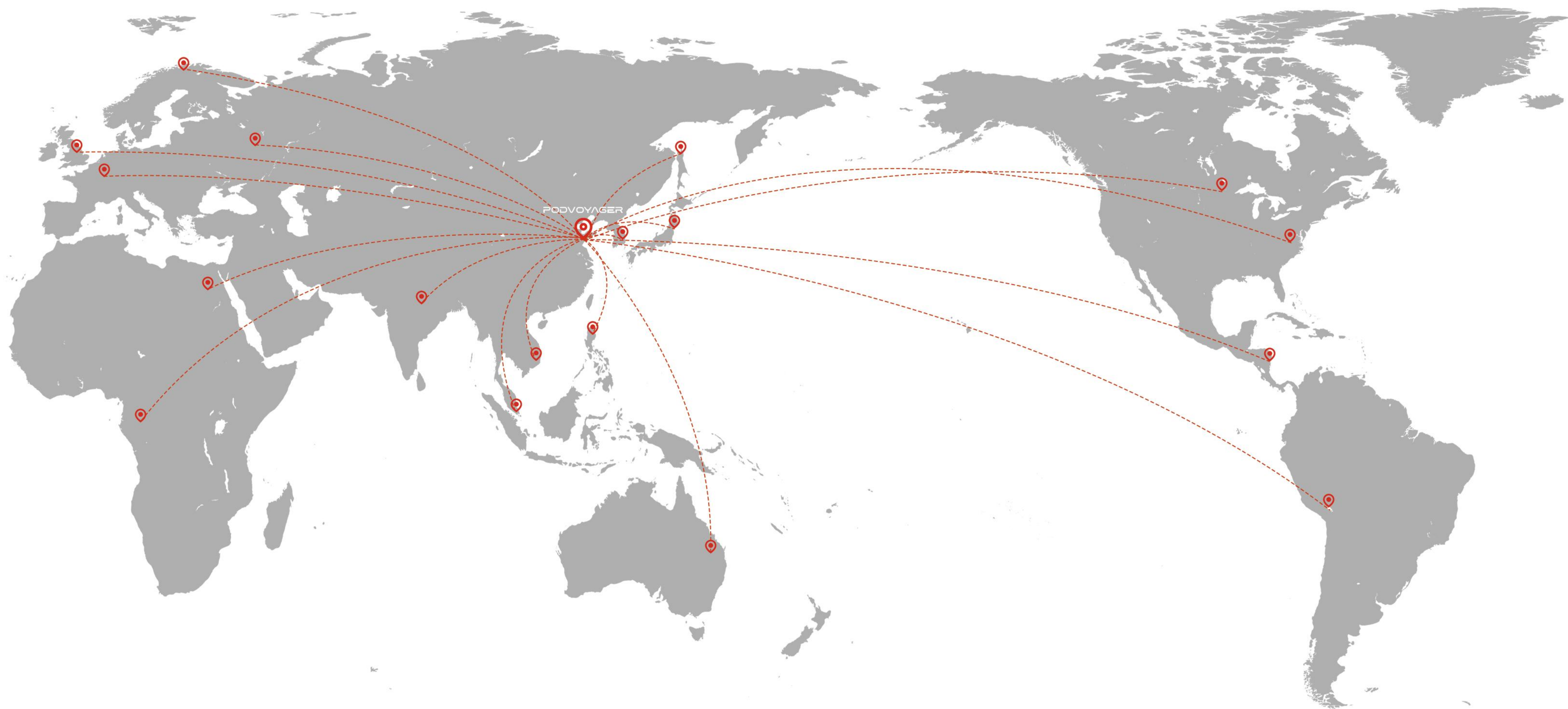

**Service Customers  
More Than 100+**

**112**

**Served More  
Than 20+ Countries**

**24**







PodVoyager-Your Capsule, Your World.

Shandong Compass Decor Material Co.,Ltd  
Address:Rm1103,A10 Building,Lushang Centre,Guangzhou Road.Linyi City Shandong,China  
Whatsapp:+86-18953955575  
Email: [angela@aesthedge.com](mailto:angela@aesthedge.com)  
[www.podvoyager.com](http://www.podvoyager.com)